

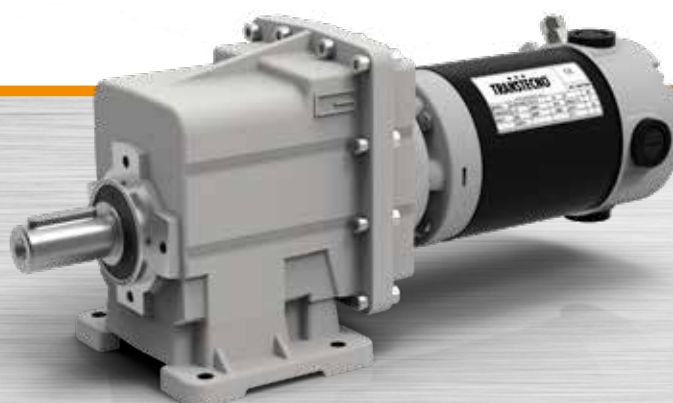

Ferrite

Motoriduttori CC ad ingranaggi cilindrici  
**DC helical in-line gearmotors**





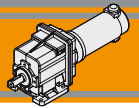

<b>Indice</b>	<b>Index</b>	Pag. Page
Caratteristiche tecniche	<i>Technical features</i>	<b>L2</b>
Designazione	<i>Classification</i>	<b>L2</b>
Sensi di rotazione	<i>Direction of rotation</i>	<b>L3</b>
Lubrificazione	<i>Lubrication</i>	<b>L3</b>
Simbologia	<i>Symbols</i>	<b>L3</b>
Carichi radiali	<i>Radial loads</i>	<b>L4</b>
Motori applicabili	<i>IEC Motor adapters</i>	<b>L4</b>
Dati tecnici per servizio S2	<i>Technical data for S2 duty</i>	<b>L5</b>
Dimensioni	<i>Dimensions</i>	<b>L9</b>

Questa sezione annulla e sostituisce ogni precedente edizione o revisione. Qualora questa sezione non Vi sia giunta in distribuzione controllata, l'aggiornamento dei dati ivi contenuto non è assicurato. **In tal caso la versione più aggiornata è disponibile sul nostro sito internet [www.transtecno.com](http://www.transtecno.com)**

*This section replaces any previous edition and revision. If you obtained this catalogue other than through controlled distribution channels, the most up to date content is not guaranteed. In this case the latest version is available on our web site [www.transtecno.com](http://www.transtecno.com)*

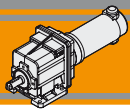

### Caratteristiche tecniche

### Technical features

Le caratteristiche principali dei motoriduttori CC ad ingranaggi cilindrici a magneti permanenti in ferrite serie ECMG sono:

- Alimentazione in bassa tensione 12/24 Vcc
- Possibilità di montaggio encoder
- Potenze motore disponibili da 100 a 800W S2
- Magneti in ferrite
- Carcasse dei riduttori in pressofusione di alluminio
- Lubrificazione permanente con olio sintetico
- Ingranaggi sempre rettificati

The main features of ECMG ferrite permanent magnets DC helical in-line gearmotors range are:

- Low voltage power supply 12/24 Vdc
- Suitable for encoder assembly
- Motor power ratings available from 100 to 800W S2
- Ferrite magnets
- Die-cast aluminum housing
- Permanent synthetic oil long-life lubrication
- Ground helical gears

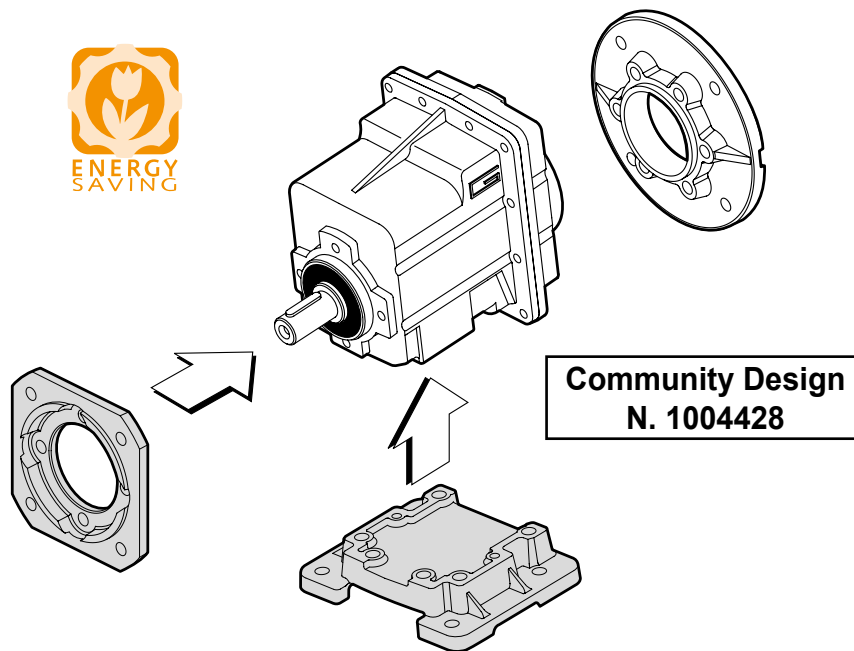

### Designazione

### Classification

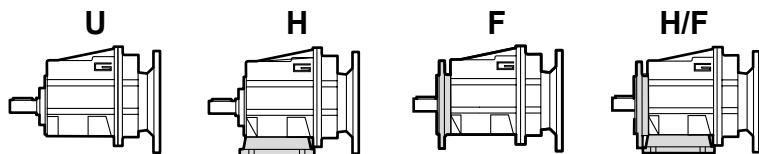

MOTORIDUTTORE / GEARMOTOR

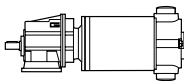
ECMG	100/002						U	8.99	D20	240
Tipo Type	Grandezza Size						Versione Version	Rapporto Ratio	Albero uscita Output shaft	Versione motore Motor version
<b>ECMG</b>  	070/002	100/002	180/002	250/002	350/002	600/002	<b>U...</b> <b>H...</b> <b>F...</b> <b>H.../F...</b>	vedi tabelle see tables	vedi tabelle see tables	<b>120</b> <b>240</b> <b>24E</b>
	070/012	100/012	180/012	250/012	350/012	600/012				
	070/013	100/013	180/013	250/013	350/013	600/013				
	070/022	100/022	180/022	250/022	350/022	600/022				
	070/023	100/023	180/023	250/023	350/023	600/023				
	070/033	100/033	180/033	250/033	350/032	600/032				
	070/043	100/043	180/043	250/043	350/033	600/033				
					350/042	600/042				
					350/043	600/043				

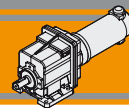

Sensi di rotazione

Direction of rotation

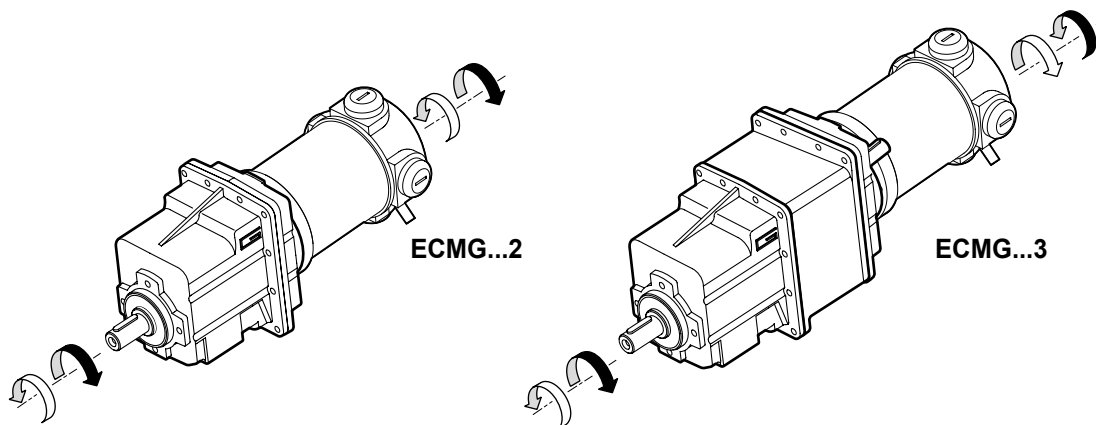

Lubrificazione

Lubrication

Tutti i riduttori sono forniti completi di lubrificante sintetico viscosità 320, pertanto possono essere installati in qualunque posizione di montaggio e non necessitano di manutenzione.

Permanent synthetic oil long-life lubrication ( viscosity grade 320) makes it possible to use in all mounting positions; for this reason they can be installed in any assembly position and do not require maintenance.

ECMG

Simbologia

Symbols

$n_1$	[min <sup>-1</sup> ]	Velocità in ingresso / <i>Input speed</i>
$n_2$	[min <sup>-1</sup> ]	Velocità in uscita / <i>Output speed</i>
$i$		Rapporto di riduzione / <i>Ratio</i>
$P_1$	[kW]	Potenza in entrata / <i>Input power</i>
$M_2$	[Nm]	Coppia nominale in uscita in funzione di $P_1$ / <i>Output torque referred to <math>P_1</math></i>
$sf$		Fattore di servizio / <i>Service factor</i>
$R_2$	[N]	Carico radiale ammissibile in uscita / <i>Permitted output radial load</i>
$A_2$	[N]	Carico assiale ammissibile in uscita / <i>Permitted output axial load</i>

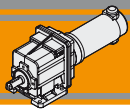

### Carichi radiali

### Radial loads

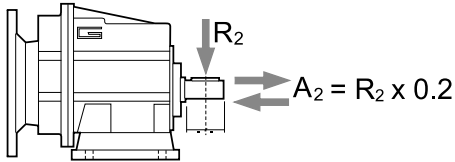

$n_2$ [min <sup>-1</sup> ]	$R_2$ [N]				
	CMG 00	CMG 01	CMG 02	CMG 03	CMG 04
700	416	764	1529	1987	2379
600	437	805	1609	2092	2504
500	465	855	1710	2223	2661
400	501	921	1842	2395	2866
250	586	1077	2154	2801	3353
180	653	1323	2554	3321	3897
150	748	1406	2714	3529	4244
120	806	1631	3467	3801	4572
100	958	1842	3684	4507	5234
80	1032	1984	3969	5042	5991
60	1136	2184	4368	5549	6594
40	1300	2500	5000	6500	8000
10	1300	2500	5000	6500	8000

Quando il carico radiale risultante non è applicato sulla mezza-  
ria dell'albero occorre calcolare quello effettivo con la seguente  
formula:

When the resulting radial load is not applied on the centre line  
of the shaft it is necessary to calculate the effective load with the  
following formula:

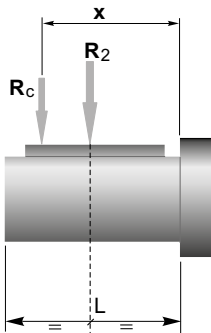

	CMG 00	CMG 01	CMG 02	CMG 03	CMG 04
<b>a</b>	73	104	117	132	150
<b>b</b>	53	84	92	102	115
<b>R<sub>2MAX</sub></b>	1300	2500	5000	6500	8000

$$R_c = \frac{R_2 \cdot a}{(b + x)} \leq R_{2MAX}$$

$$R \leq R_c$$

*a, b = valori riportati nella tabella  
a, b = values given in the table*

### Motori applicabili

### IEC Motor adapters

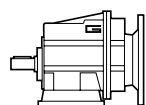
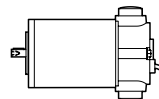

		EC						
		070.12E 070.24E	100.120 100.240 100.24E	180.120 180.240	180.24E	250.120 250.240	350.120 350.240	600.120 600.240
<b>CMG</b>	<b>002</b>	5.03 - 55.10						
	<b>012</b>	3.82 - 60.15						
	<b>013</b>	63.22 - 443.59						
	<b>022</b>	3.66 - 60.90						
	<b>023</b>	64.01 - 449.14						
	<b>032</b>						3.74 - 60.80	
	<b>033</b>	72.83 - 427.03						
	<b>042</b>						3.74 - 60.80	
	<b>043</b>	72.83 - 427.03						

5.03 - 55.10

Rapporti di riduzione i  
Ratio i

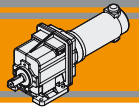

Dati tecnici per servizio S2

Technical data for S2 duty

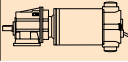
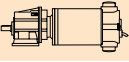
P <sub>1</sub> [W]	n <sub>2</sub> [min <sup>-1</sup> ]	M <sub>2</sub> [Nm]	sf	i		Versione motore Motor version	P <sub>1</sub> [W]	n <sub>2</sub> [min <sup>-1</sup> ]	M <sub>2</sub> [Nm]	sf	i		Versione motore Motor version
<b>100</b>							<b>140</b>						
(3000 min <sup>-1</sup> )	<b>596</b>	1.5	20.2	5.03	<b>070/002</b>	12E/24E	(3000 min <sup>-1</sup> )	<b>596</b>	2.2	14.4	5.03	<b>100/002</b>	120/240/24E
	<b>492</b>	1.9	16.6	6.10				<b>492</b>	2.6	11.9	6.10		
	<b>401</b>	2.3	13.5	7.49				<b>401</b>	3.2	9.7	7.49		
	<b>334</b>	2.7	14.2	8.99				<b>334</b>	3.8	10.1	8.99		
	<b>295</b>	3.1	12.6	10.16				<b>295</b>	4.3	9.0	10.16		
	<b>249</b>	3.7	10.6	12.07				<b>249</b>	5.2	7.6	12.07		
	<b>224</b>	4.1	13.4	13.40				<b>224</b>	5.7	9.6	13.40		
	<b>198</b>	4.6	11.9	15.14				<b>198</b>	6.5	8.5	15.14		
	<b>165</b>	5.5	9.9	18.17				<b>165</b>	7.8	7.1	18.17		
	<b>139</b>	6.6	8.3	21.58				<b>139</b>	9.2	6.0	21.58		
	<b>128</b>	7.2	7.7	23.51				<b>128</b>	10	5.5	23.51		
	<b>120</b>	7.7	7.2	25.10				<b>120</b>	11	5.1	25.10		
	<b>111</b>	8.3	6.6	27.08				<b>111</b>	12	4.7	27.08		
	<b>92</b>	9.9	5.5	32.49				<b>92</b>	14	4.0	32.49		
	<b>71</b>	13	4.3	42.04				<b>71</b>	18	3.1	42.04		
	<b>67</b>	14	4.0	44.89				<b>67</b>	19	2.9	44.89		
	<b>61</b>	15	3.7	48.86				<b>61</b>	21	2.6	48.86		
	<b>54</b>	17	3.3	55.10				<b>54</b>	24	2.3	55.10		
	<b>61</b>	15	6.3	49.00	<b>070/012</b>	12E/24E		<b>85</b>	15	6.2	35.47	<b>100/012</b>	120/240/24E
	<b>56</b>	16	5.8	53.33				<b>65</b>	20	4.8	45.89		
	<b>50</b>	18	5.1	60.15				<b>61</b>	21	4.5	49.00		
								<b>56</b>	23	4.1	53.33		
	<b>47</b>	19	5.0	63.22	<b>070/013</b>	12E/24E		<b>50</b>	26	3.7	60.15		
	<b>40</b>	22	4.2	75.08				<b>47</b>	26	3.5	63.22	<b>100/013</b>	120/240/24E
	<b>34</b>	27	3.5	89.17				<b>40</b>	31	3.0	75.08		
	<b>27</b>	34	2.8	113.05				<b>34</b>	37	2.5	89.17		
	<b>22</b>	40	2.3	134.27				<b>27</b>	47	2.0	113.05		
	<b>17</b>	52	1.8	173.72				<b>22</b>	56	1.7	134.27		
	<b>15</b>	60	1.6	202.16				<b>17</b>	73	1.3	173.72		
	<b>11</b>	78	1.2	261.57				<b>15</b>	85	1.1	202.16		
	<b>10</b>	91	1.0	304.00				<b>11</b>	110	0.9	261.57		
	<b>7.6</b>	118	0.8	393.33				<b>10</b>	127	0.7	304.00		
	<b>6.8</b>	133	0.7	443.59				<b>7.6</b>	134	0.7	393.33		
								<b>6.8</b>	134	0.7	443.59		
	<b>22</b>	41	3.8	135.95	<b>070/023</b>	12E/24E		<b>33</b>	38	4.1	90.29	<b>100/023</b>	120/240/24E
	<b>17</b>	53	3.0	175.89				<b>26</b>	48	3.3	114.46		
	<b>15</b>	61	2.5	204.69				<b>22</b>	57	2.7	135.95		
	<b>11</b>	79	2.0	264.84				<b>17</b>	74	2.1	175.89		
	<b>10</b>	92	1.7	307.80				<b>15</b>	86	1.8	204.69		
	<b>7.5</b>	119	1.3	398.25				<b>11</b>	111	1.4	264.84		
	<b>6.7</b>	134	1.2	449.14				<b>10</b>	129	1.2	307.80		
								<b>7.5</b>	167	0.9	398.25		
	<b>13</b>	67	3.5	225.47	<b>070/033</b>	12E/24E		<b>6.7</b>	188	0.8	449.14		
	<b>11</b>	78	3.0	262.05				<b>17</b>	73	3.2	174.26	<b>100/033</b>	120/240/24E
	<b>9.2</b>	97	2.4	325.79				<b>13</b>	94	2.5	225.47		
	<b>7.9</b>	113	2.1	378.64				<b>11</b>	110	2.1	262.05		
	<b>7.0</b>	128	1.8	427.03				<b>9.2</b>	136	1.7	325.79		
								<b>7.9</b>	159	1.5	378.64		
	<b>9.2</b>	97	4.0	325.79	<b>070/043</b>	12E/24E		<b>7.0</b>	179	1.3	427.03		
	<b>7.9</b>	113	3.4	378.64				<b>11</b>	110	3.6	262.05	<b>100/043</b>	120/240/24E
	<b>7.0</b>	128	3.1	427.03				<b>9.2</b>	136	2.9	325.79		
								<b>7.9</b>	159	2.5	378.64		
								<b>7.0</b>	179	2.2	427.03		

NOTA  
Verificare sempre che la coppia M2 utilizzata non  
ecceda il valore indicato nelle caselle in grigio  
NOTE  
Please check that the output torque M2 does not  
exceed the value in the grey areas





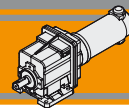

Dati tecnici per servizio S2

Technical data for S2 duty

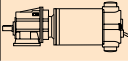
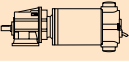
P <sub>1</sub> [W]	n <sub>2</sub> [min <sup>-1</sup> ]	M <sub>2</sub> [Nm]	sf	i		Versione motore Motor version	P <sub>1</sub> [W]	n <sub>2</sub> [min <sup>-1</sup> ]	M <sub>2</sub> [Nm]	sf	i		Versione motore Motor version			
<b>350</b>							<b>500</b>									
(3000 min <sup>-1</sup> )	<b>84</b>	38	4.1	35.91	<b>250/022</b>	120/240	(3000 min <sup>-1</sup> )	<b>785</b>	5.8	8.1	3.82	<b>350/012</b>	120/240			
	<b>65</b>	50	3.1	46.46					<b>648</b>	7.1	6.6			4.63		
	<b>60</b>	53	2.9	49.61					<b>527</b>	8.7	5.4			5.69		
	<b>56</b>	58	2.7	54.00					<b>389</b>	12	5.3			7.72		
	<b>49</b>	65	2.4	60.90					<b>327</b>	14	4.4			9.17		
	<b>47</b>	67	2.3	64.01			<b>250/023</b>	120/240	<b>306</b>	15	4.1			9.81		
	<b>39</b>	80	2.0	76.02							<b>261</b>			18	4.4	11.5
	<b>33</b>	95	1.6	90.29							<b>252</b>			18	4.3	11.9
	<b>26</b>	120	1.3	114.46							<b>217</b>			21	4.5	13.80
	<b>22</b>	142	1.1	135.95							<b>205</b>			22	4.2	14.62
	<b>17</b>	184	0.8	175.89					<b>168</b>	27	3.4	17.86				
	<b>15</b>	214	0.7	204.69					<b>157</b>	29	3.2	19.07				
	<b>11</b>	223	0.7	264.84					<b>151</b>	30	3.1	19.83				
	<b>41</b>	76	3.1	72.83	<b>250/033</b>	120/240			<b>127</b>	36	2.6	23.56				
	<b>31</b>	102	2.3	97.45							<b>101</b>	45	2.1	29.56		
	<b>26</b>	121	1.9	115.74					<b>85</b>	54	1.7	35.47				
	<b>21</b>	147	1.6	140.81					<b>65</b>	70	1.3	45.89				
	<b>17</b>	183	1.3	174.26					<b>61</b>	75	1.3	49.00				
	<b>13</b>	236	1.0	225.47					<b>56</b>	81	1.2	53.33				
	<b>11</b>	274	0.9	262.05					<b>50</b>	92	1.0	60.15				
	<b>9.2</b>	341	0.7	325.79					<b>47</b>	95	1.0	63.22				
	<b>7.9</b>	334	0.7	378.64					<b>40</b>	112	0.8	75.08				
	<b>7.0</b>	334	0.7	427.03					<b>34</b>	133	0.7	89.17				
	<b>41</b>	76	5.1	72.83	<b>250/043</b>	120/240	<b>27</b>	134	0.7	113.05						
	<b>31</b>	102	3.8	97.45					<b>22</b>	134	0.7	134.27				
	<b>26</b>	121	3.2	115.74					<b>126</b>	36	4.3	23.85				
	<b>21</b>	147	2.6	140.81					<b>100</b>	46	3.4	29.93				
	<b>17</b>	183	2.1	174.26					<b>84</b>	55	2.8	35.91				
	<b>13</b>	236	1.7	225.47					<b>65</b>	71	2.2	46.46				
	<b>11</b>	274	1.4	262.05					<b>60</b>	76	2.1	49.61				
	<b>9.2</b>	341	1.1	325.79					<b>56</b>	83	1.9	54.00				
	<b>7.9</b>	397	1.0	378.64					<b>49</b>	93	1.7	60.90				
	<b>7.0</b>	447	0.9	427.03					<b>47</b>	96	1.6	64.01				
	<b>596</b>	7.7	4.0	5.03	<b>350/002</b>	120/240	<b>39</b>	114	1.4	76.02						
(3000 min <sup>-1</sup> )	<b>492</b>	9.3	3.3	6.10					<b>33</b>	135	1.2	90.29				
	<b>401</b>	11	2.7	7.49					<b>26</b>	171	0.9	114.46				
	<b>334</b>	14	2.8	8.99					<b>22</b>	203	0.8	135.95				
	<b>295</b>	16	2.5	10.16					<b>17</b>	223	0.7	175.89				
	<b>249</b>	18	2.1	12.07					<b>98</b>	47	5.0	30.57				
	<b>224</b>	20	2.7	13.40					<b>88</b>	52	4.5	34.20				
	<b>198</b>	23	2.4	15.14					<b>78</b>	59	4.0	38.63				
	<b>165</b>	28	2.0	18.17					<b>68</b>	68	3.5	44.18				
	<b>139</b>	33	1.7	21.58					<b>58</b>	78	3.0	51.30				
	<b>128</b>	36	1.5	23.51			<b>49</b>	93	2.5	60.80						
	<b>120</b>	38	1.4	25.1			<b>41</b>	109	2.1	72.83						
	<b>111</b>	41	1.3	27.08			<b>31</b>	146	1.6	97.45						
	<b>92</b>	50	1.1	32.49			<b>26</b>	173	1.4	115.74						
	<b>71</b>	64	0.9	42.04			<b>21</b>	211	1.1	140.81						
	<b>67</b>	69	0.8	44.89			<b>17</b>	261	0.9	174.26						
	<b>61</b>	75	0.7	48.86			<b>13</b>	334	0.7	225.47						
							<b>11</b>	334	0.7	262.05						
							<b>58</b>	78	5.0	51.30						
							<b>49</b>	93	4.0	60.80						

NOTA  
Verificare sempre che la coppia M<sub>2</sub> utilizzata non ecceda il valore indicato nelle caselle in grigio  
NOTE  
Please check that the output torque M<sub>2</sub> does not exceed the value in the grey areas

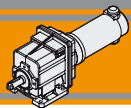

### Dati tecnici per servizio S2

### Technical data for S2 duty

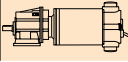
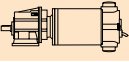
$P_1$ [W]	$n_2$ [min <sup>-1</sup> ]	$M_2$ [Nm]	sf	i		Versione motore Motor version	$P_1$ [W]	$n_2$ [min <sup>-1</sup> ]	$M_2$ [Nm]	sf	i		Versione motore Motor version				
<b>500</b>							<b>800</b>										
(3000 min <sup>-1</sup> )	<b>41</b>	109	3.6	72.83	<b>350/043</b>	120/240	(3000 min <sup>-1</sup> )	<b>302</b>	24	3.9	9.93	<b>600/022</b>	120/240				
	<b>31</b>	146	2.7	97.45													
	<b>26</b>	173	2.3	115.74													
	<b>21</b>	211	1.9	140.81													
	<b>17</b>	261	1.5	174.26													
	<b>13</b>	337	1.2	225.47													
	<b>11</b>	392	1.0	262.05													
	<b>9.2</b>	487	0.8	325.79													
	<b>7.9</b>	557	0.7	378.64													
	<b>7.0</b>	557	0.7	427.03													
<b>800</b>							<b>800</b>										
(3000 min <sup>-1</sup> )	<b>596</b>	12	2.5	5.03	<b>600/002</b>	120/240	(3000 min <sup>-1</sup> )	<b>302</b>	24	3.9	9.93	<b>600/022</b>	120/240				
	<b>492</b>	15	2.1	6.10													
	<b>401</b>	18	1.7	7.49													
	<b>334</b>	22	1.8	8.99													
	<b>295</b>	25	1.6	10.16													
	<b>249</b>	30	1.3	12.07													
	<b>224</b>	33	1.7	13.40													
	<b>198</b>	37	1.5	15.14													
	<b>165</b>	44	1.2	18.17													
	<b>139</b>	53	1.0	21.58													
	<b>128</b>	57	1.0	23.51													
	<b>120</b>	61	0.9	25.10													
	<b>111</b>	66	0.8	27.08													
	<b>92</b>	79	0.7	32.49													
	<b>71</b>	79	0.7	42.04													
	<b>67</b>	79	0.7	44.89													
	<b>785</b>	9	5.0	3.82			<b>600/012</b>	120/240		<b>47</b>	153			1.0	64.01	<b>600/023</b>	120/240
	<b>648</b>	11	4.2	4.63													
	<b>527</b>	14	3.4	5.69													
	<b>389</b>	19	3.3	7.72													
	<b>327</b>	22	2.8	9.17													
	<b>306</b>	24	2.6	9.81													
	<b>261</b>	28	2.8	11.5													
	<b>252</b>	29	2.7	11.9													
	<b>217</b>	34	2.8	13.8													
	<b>205</b>	36	2.6	14.62													
	<b>168</b>	44	2.2	17.86													
	<b>157</b>	47	2.0	19.07													
	<b>151</b>	48	1.9	19.83													
	<b>127</b>	58	1.6	23.56													
	<b>101</b>	72	1.3	29.56													
	<b>85</b>	87	1.1	35.47													
	<b>65</b>	112	0.8	45.89													
	<b>61</b>	120	0.8	49.00													
	<b>56</b>	130	0.7	53.33													
	<b>47</b>	134	0.7	63.22	<b>600/013</b>	120/240		<b>41</b>	174	1.3	72.83	<b>600/032</b>	120/240				
	<b>40</b>	134	0.7	75.08													
								<b>98</b>	75	3.1	30.57						
								<b>88</b>	84	2.8	34.20						
								<b>78</b>	94	2.5	38.63						
								<b>68</b>	108	2.2	44.18						
								<b>58</b>	125	1.9	51.30						
								<b>49</b>	149	1.6	60.80						
								<b>120</b>	61	3.8	24.99						
								<b>98</b>	75	3.1	30.57						
								<b>88</b>	84	2.8	34.20						
								<b>78</b>	94	2.5	38.63						
								<b>68</b>	108	2.2	44.18						
								<b>58</b>	125	1.9	51.30						
								<b>49</b>	149	1.6	60.80						
								<b>33</b>	216	0.7	90.29						
								<b>26</b>	223	0.7	114.46						
								<b>22</b>	223	0.7	135.95						
								<b>41</b>	174	1.3	72.83						
								<b>31</b>	233	1.0	97.45						
								<b>26</b>	277	0.8	115.74						
								<b>21</b>	334	0.7	140.81						
								<b>17</b>	334	0.7	174.26						
								<b>78</b>	94	4.1	38.63						
								<b>68</b>	108	3.6	44.18						
								<b>58</b>	125	3.1	51.30						
								<b>49</b>	149	2.5	60.80						
								<b>41</b>	174	2.2	72.83						
								<b>31</b>	233	1.7	97.45						
								<b>26</b>	277	1.4	115.74						
								<b>21</b>	337	1.2	140.81						
								<b>17</b>	417	0.9	174.26						
								<b>13</b>	540	0.7	225.47						
								<b>11</b>	557	0.7	262.05						
								<b>9</b>	557	0.7	325.79						

**NOTA**

Verificare sempre che la coppia  $M_2$  utilizzata non ecceda il valore indicato nelle caselle in grigio

**NOTE**

Please check that the output torque  $M_2$  does not exceed the value in the grey areas

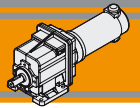

Dimensioni

Dimensions

ECMG..U

ECMG070/002 U

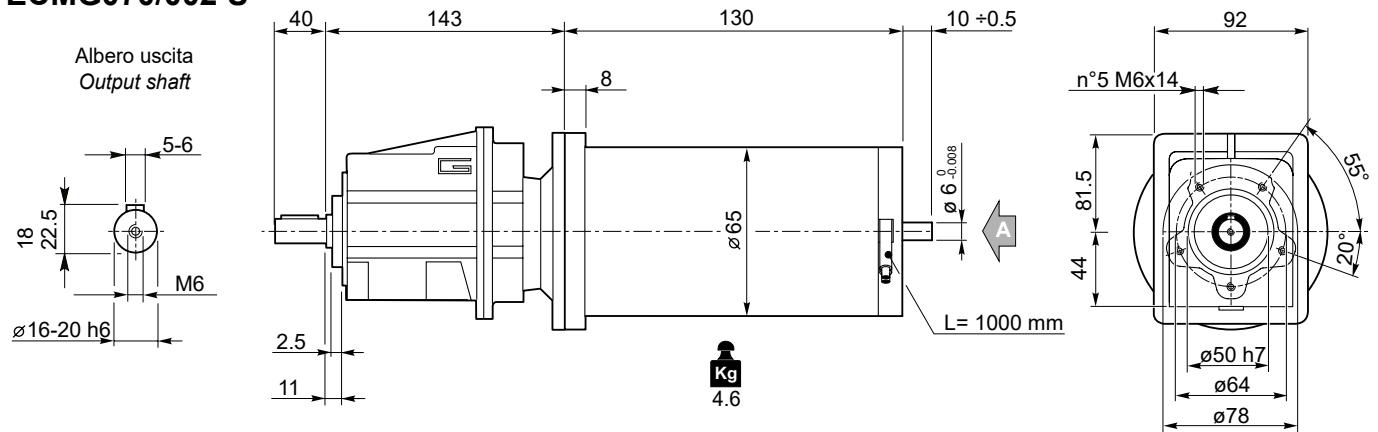

ECMG070/012 U

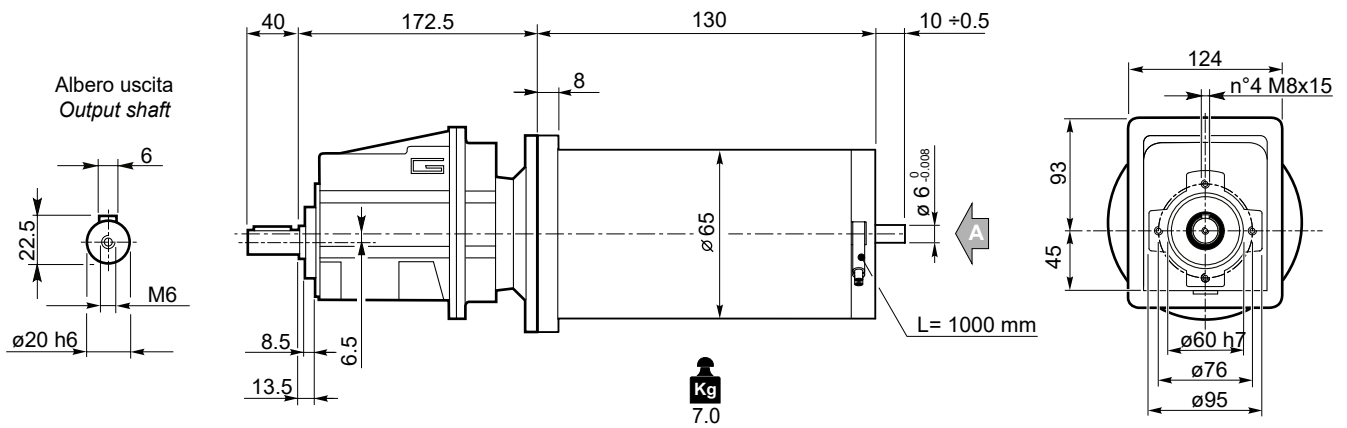

ECMG070/013 U

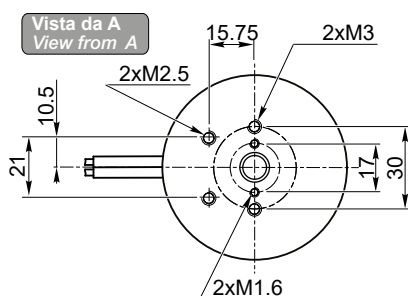
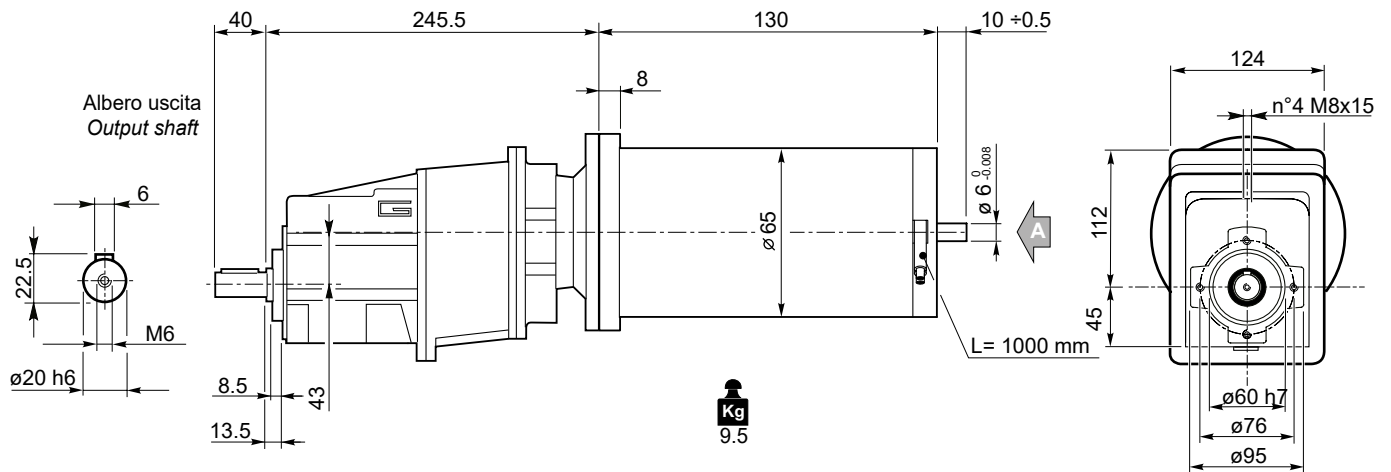

Freno / Brake



H23

Encoder



H24

Motori / Motors IP66



I2

ECMG...H



L30

ECMG...F



L31

ECMG...H/F



L32

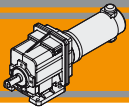

### Dimensioni

### Dimensions

## ECMG..U

### ECMG070/022 U

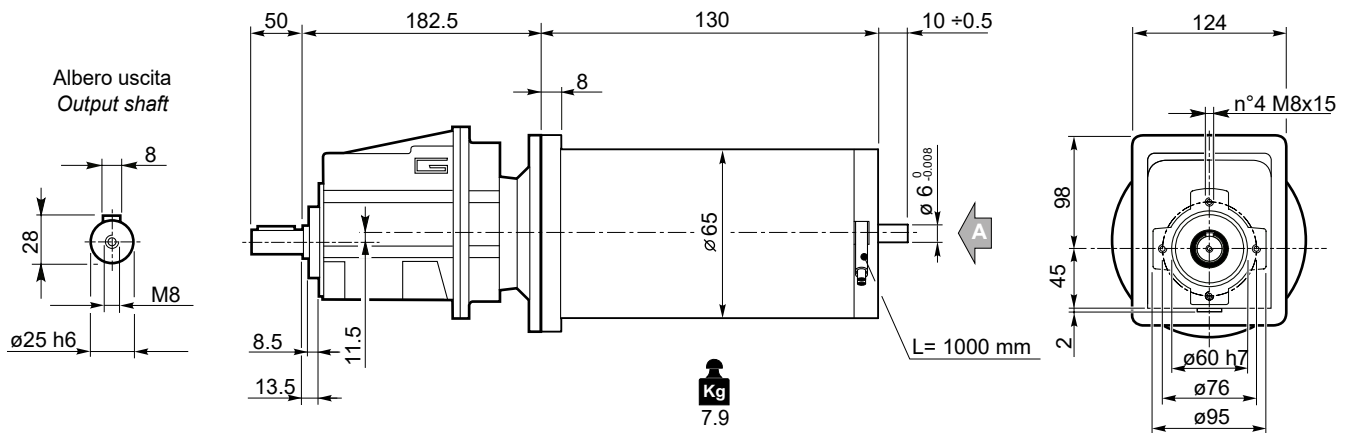

### ECMG070/023 U

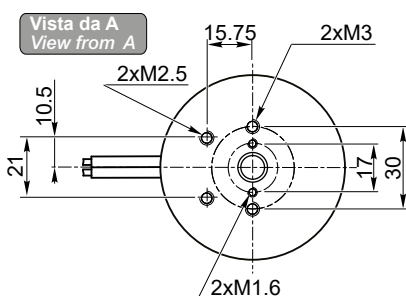
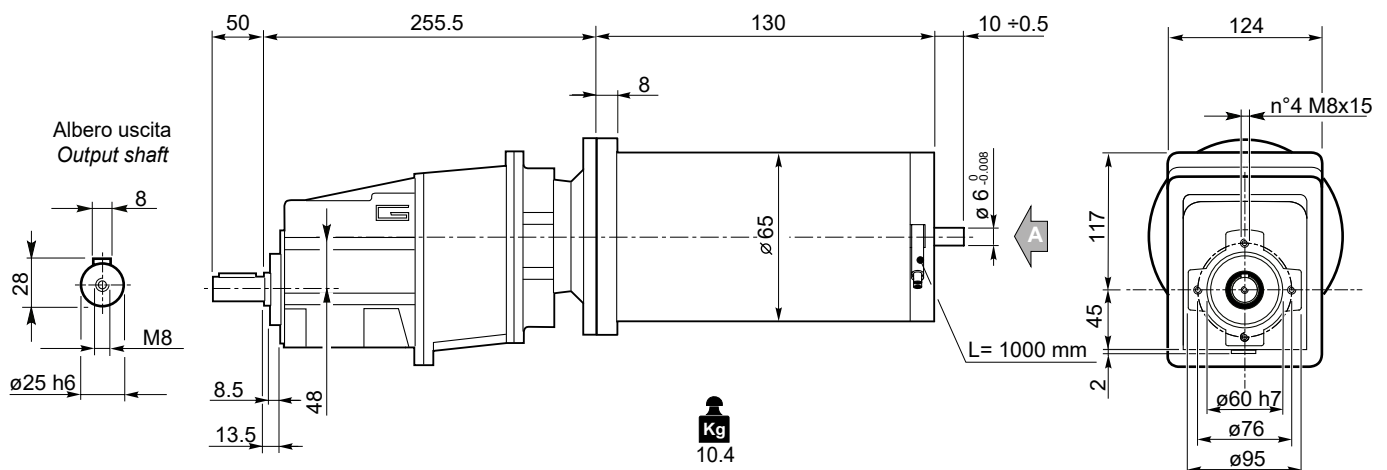

Freno / Brake



H23

ECMG...H



L30

Encoder



H24

ECMG...F



L31

Motori / Motors IP66



I2

ECMG...H/F



L32

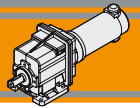

Dimensioni

Dimensions

ECMG..U

ECMG070/033 U

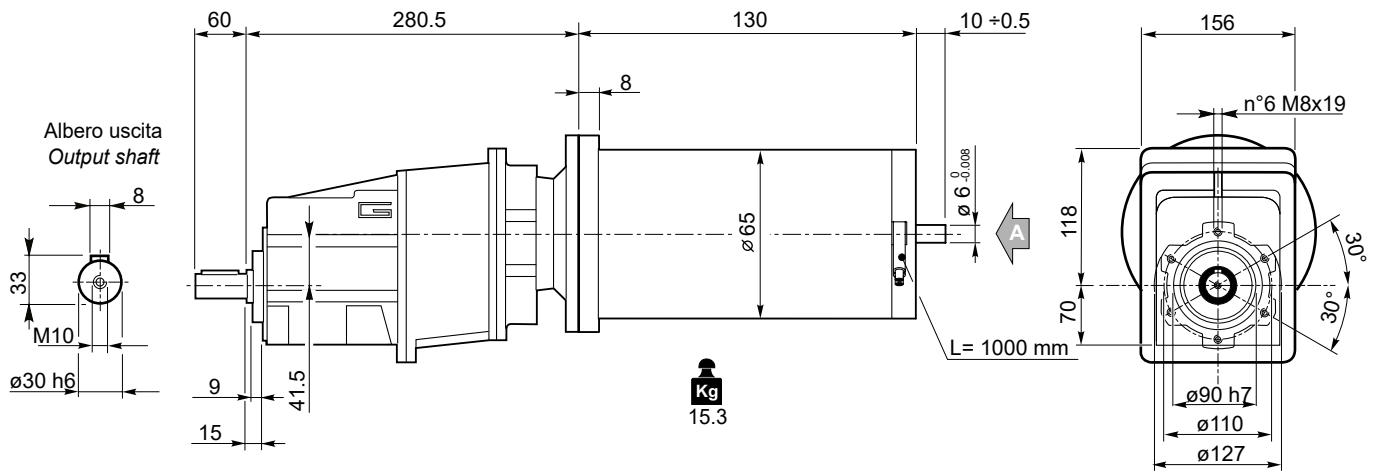

ECMG070/043 U

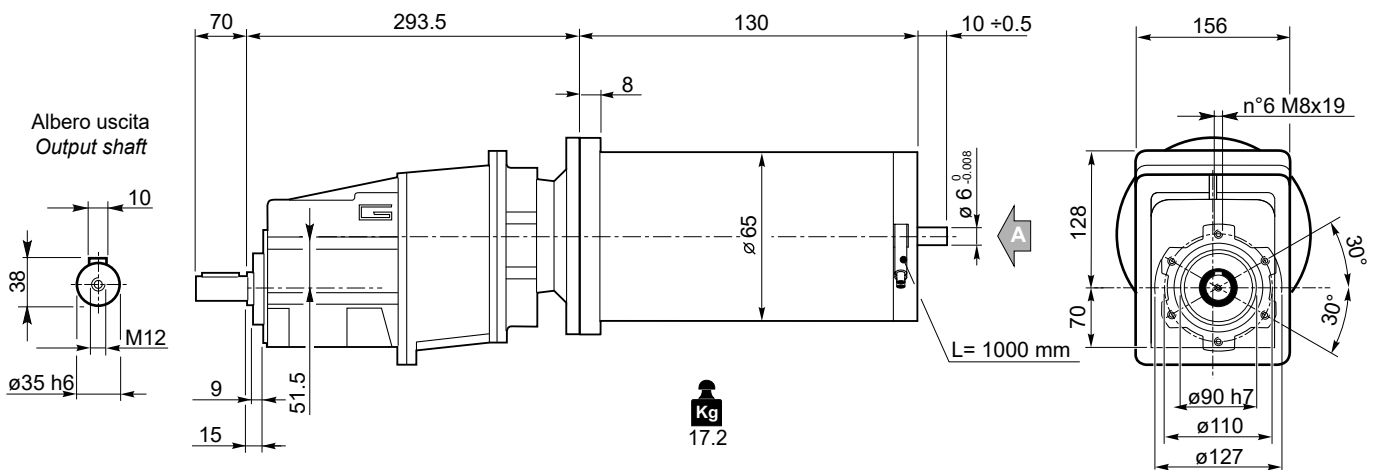

ECMG

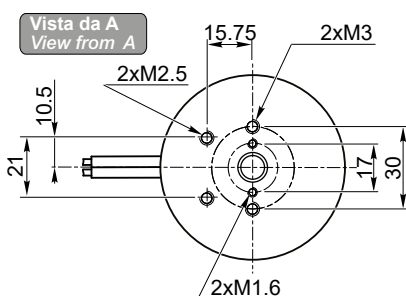

Freno / Brake



H23

Encoder



H24

Motori / Motors IP66



I2

ECMG...H



L30

ECMG...F



L31

ECMG...H/F



L32

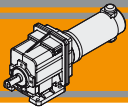

### Dimensioni

### Dimensions

## ECMG..U

### ECMG100/002 U

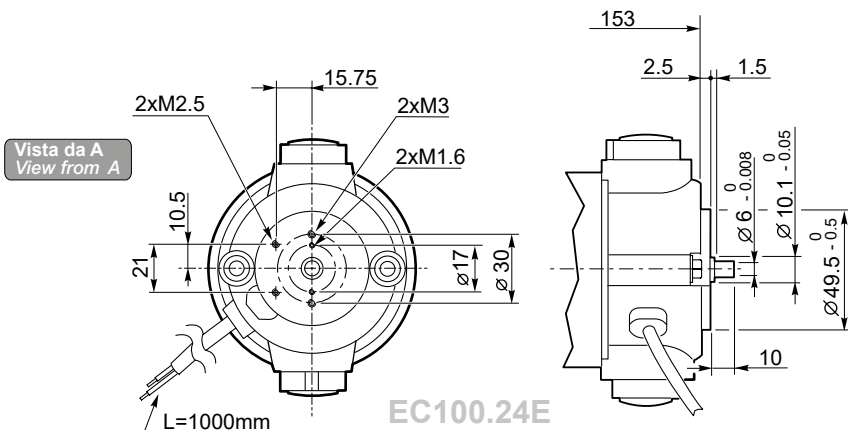
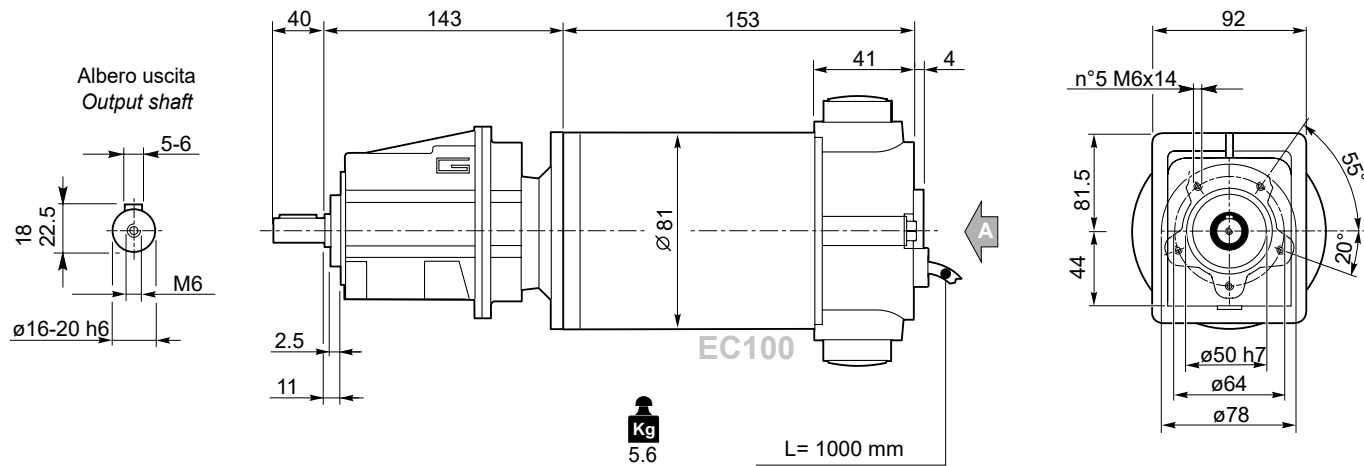

Freno / Brake

H23

Encoder

H24

Motori / Motors IP66

I4

ECMG...H

L30

ECMG...F

L31

ECMG...H/F

L32

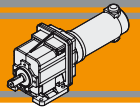

Dimensioni

Dimensions

ECMG..U

ECMG100/012 U

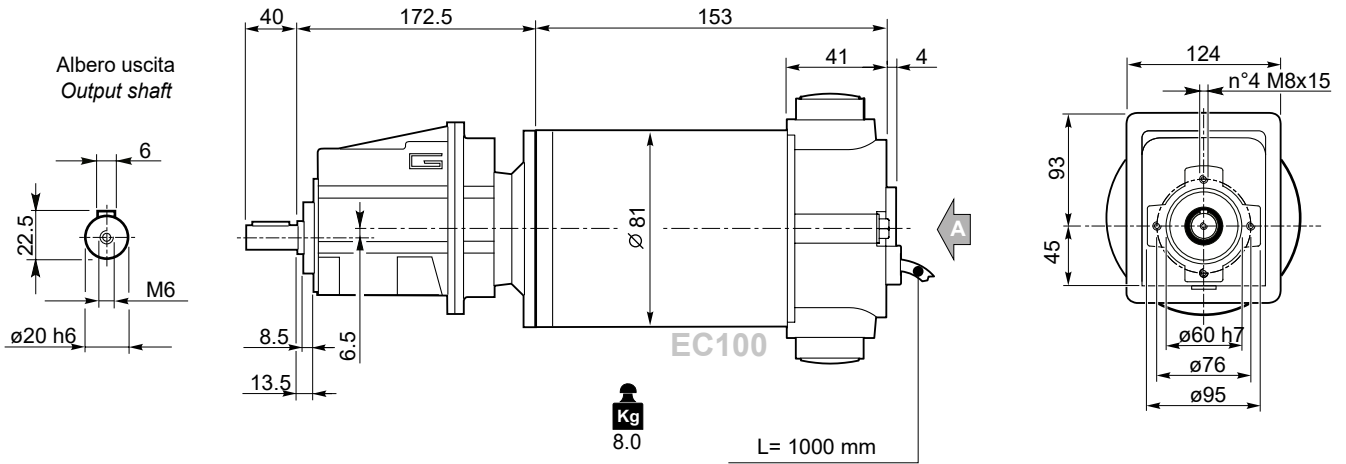

ECMG100/013 U

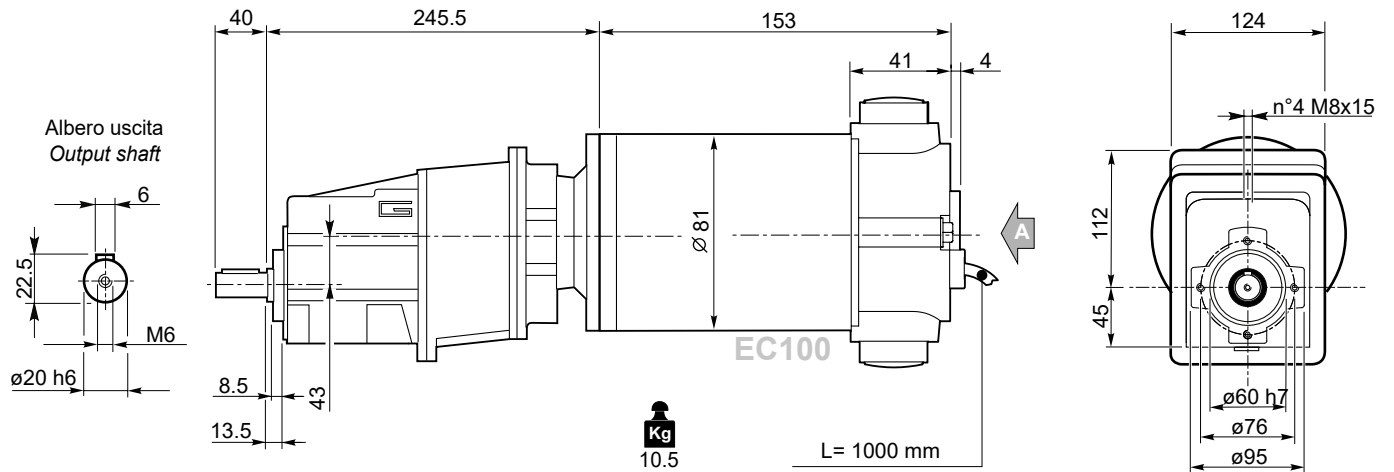

ECMG

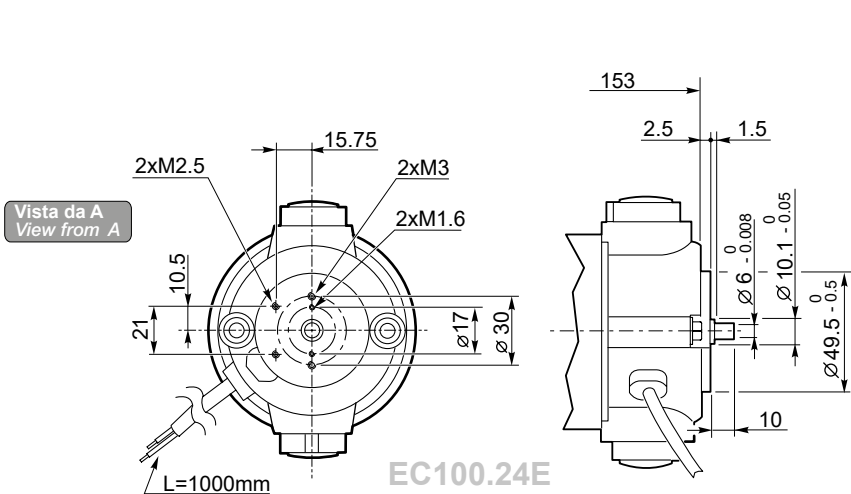

Freno / Brake → H23

Encoder → H24

Motori / Motors IP66 → I4

ECMG...H → L30

ECMG...F → L31

ECMG...H/F → L32

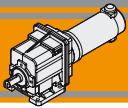

### Dimensioni

## ECMG..U

### ECMG100/022 U

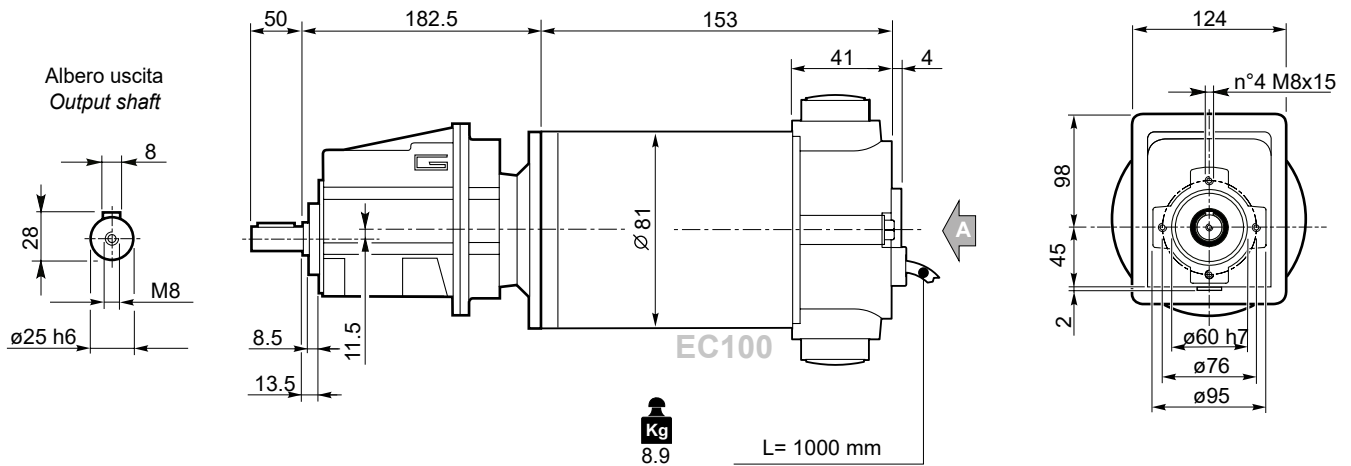

### ECMG100/023 U

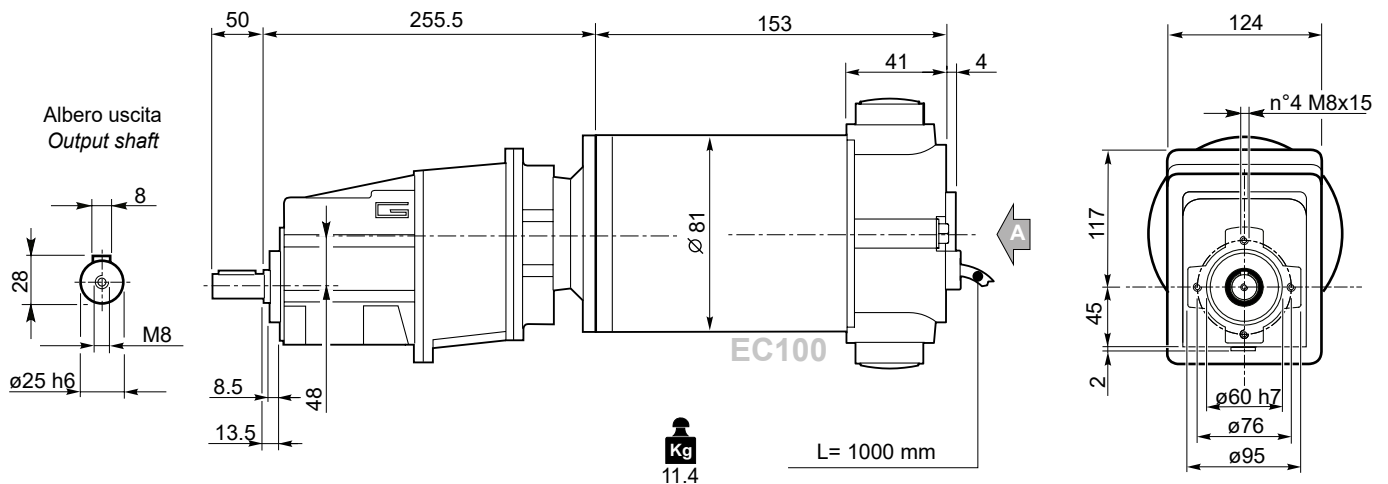

Freno / Brake

H23

Encoder

H24

Motori / Motors IP66

I4

ECMG...H

L30

ECMG...F

L31

ECMG...H/F

L32

Vista da A  
View from A

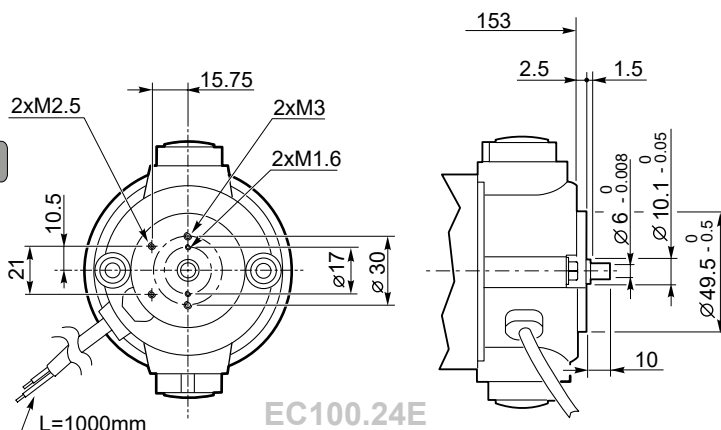



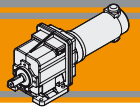

Dimensioni

ECMG..U

ECMG100/033 U

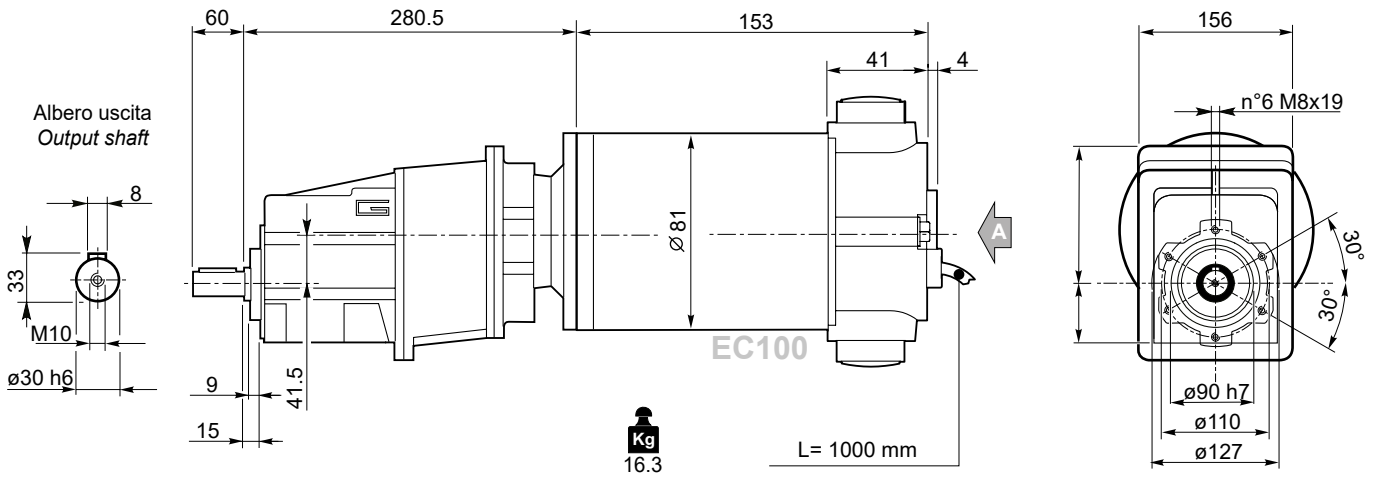

ECMG100/043 U

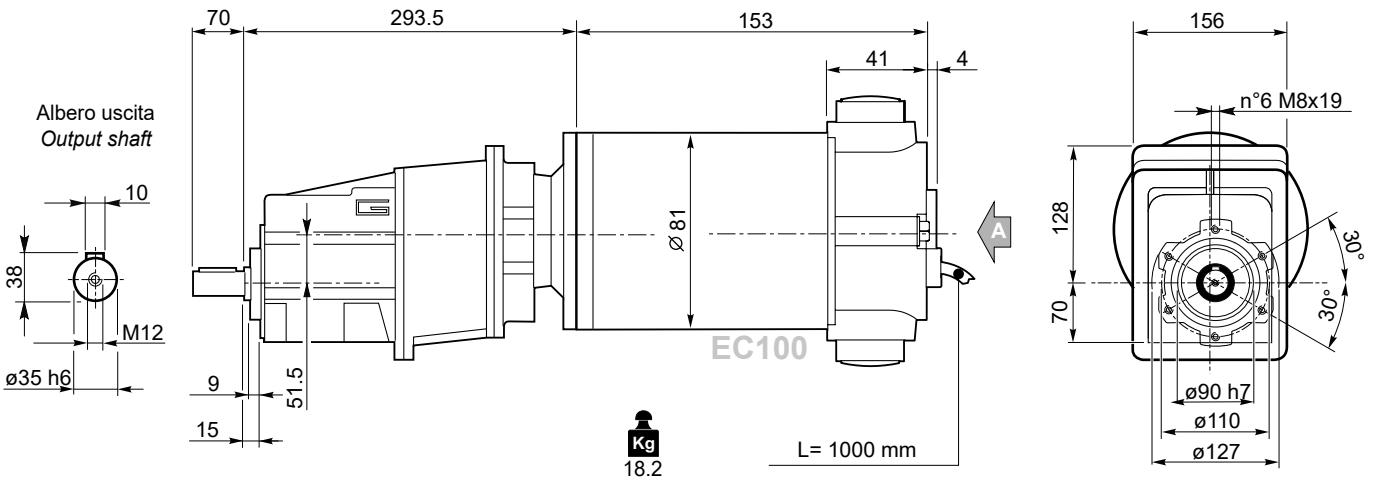

ECMG

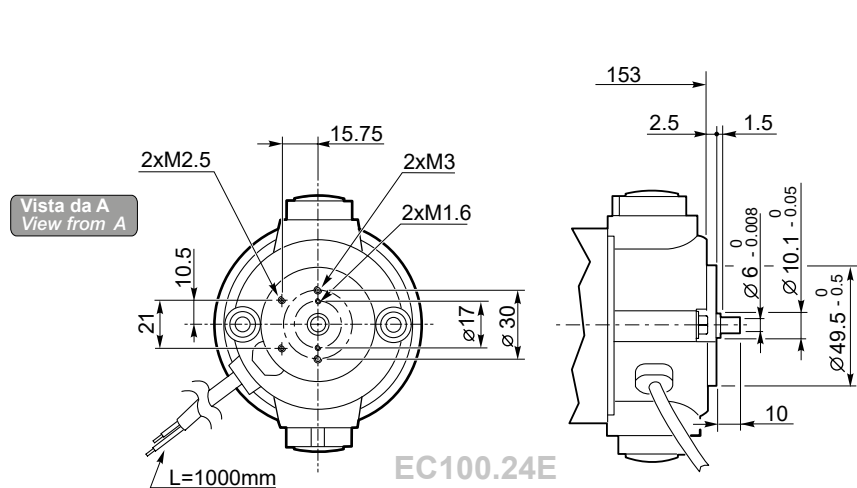

Freno / Brake → H23

Encoder → H24

Motori / Motors IP66 → I4

ECMG...H → L30

ECMG...F → L31

ECMG...H/F → L32

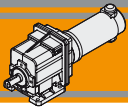

### Dimensioni

### Dimensions

## ECMG..U

### ECMG180/002 U

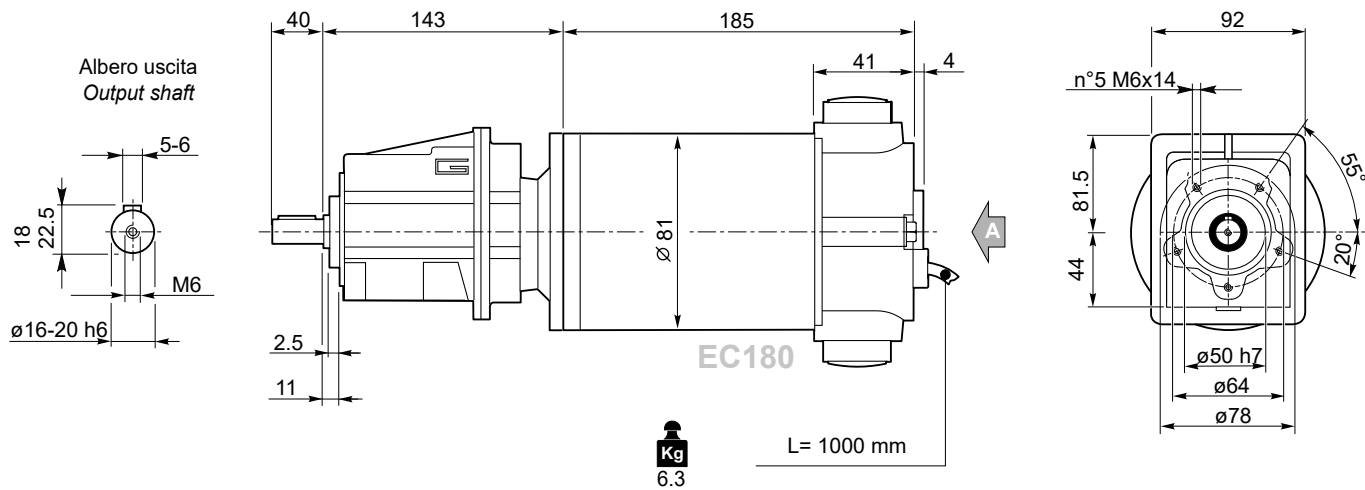

Vista da A  
View from A

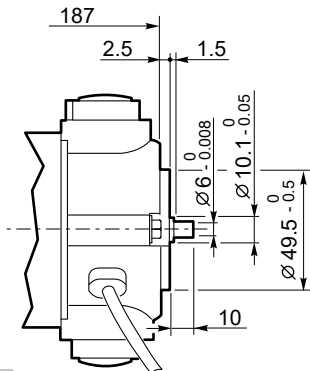
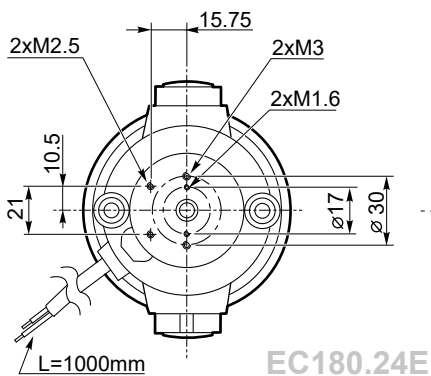

Freno / Brake

H23

Encoder

H24

Motori / Motors IP66

I6

ECMG...H

L30

ECMG...F

L31

ECMG...H/F

L32

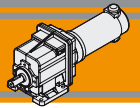

Dimensioni

Dimensions

ECMG..U

ECMG180/012 U

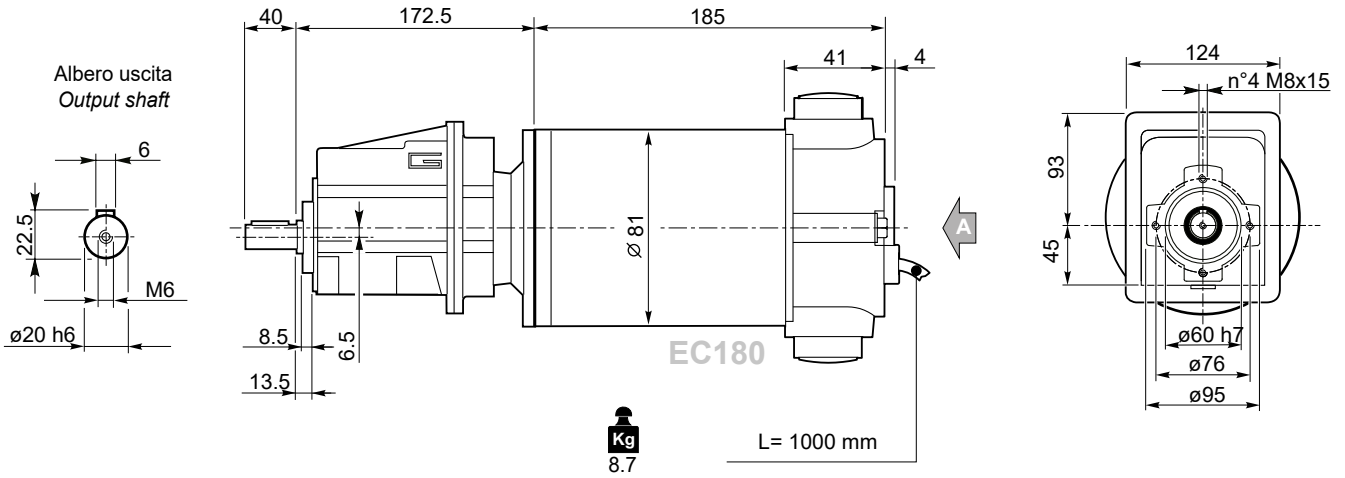

ECMG180/013 U

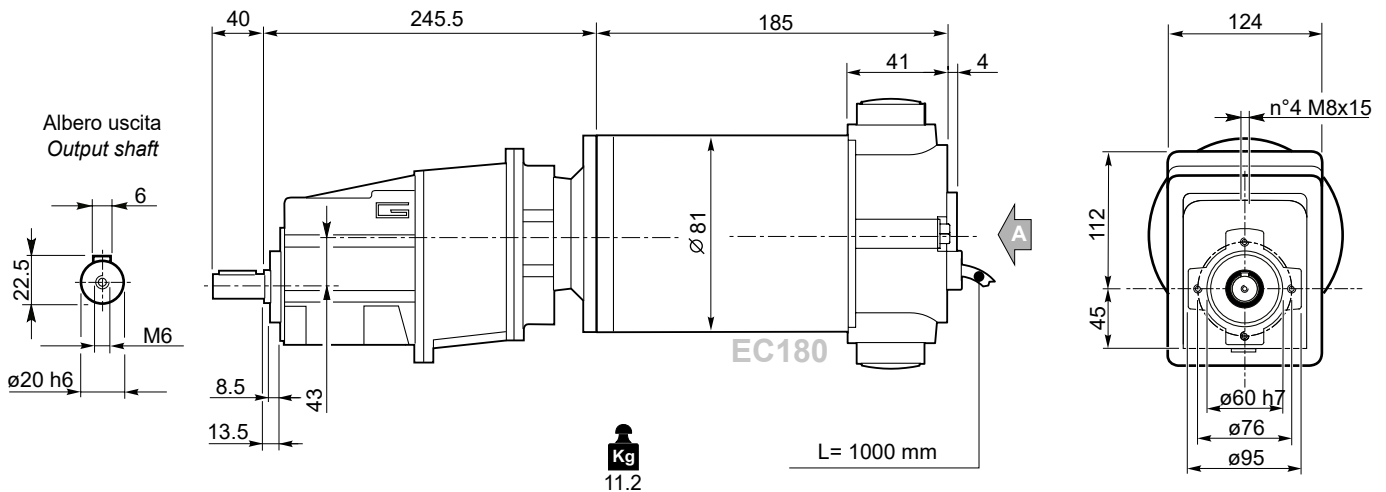

ECMG

Freno / Brake → H23

Encoder → H24

Motori / Motors IP66 → I6

ECMG...H → L30

ECMG...F → L31

ECMG...H/F → L32

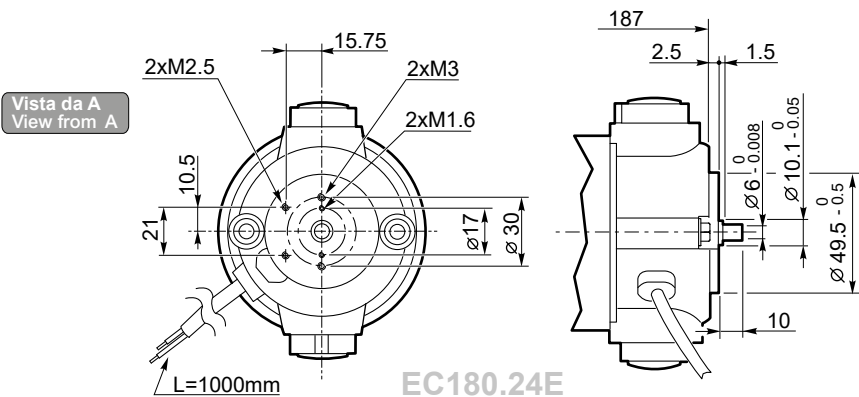

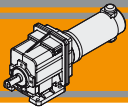

### Dimensioni

### Dimensions

## ECMG..U

### ECMG180/022 U

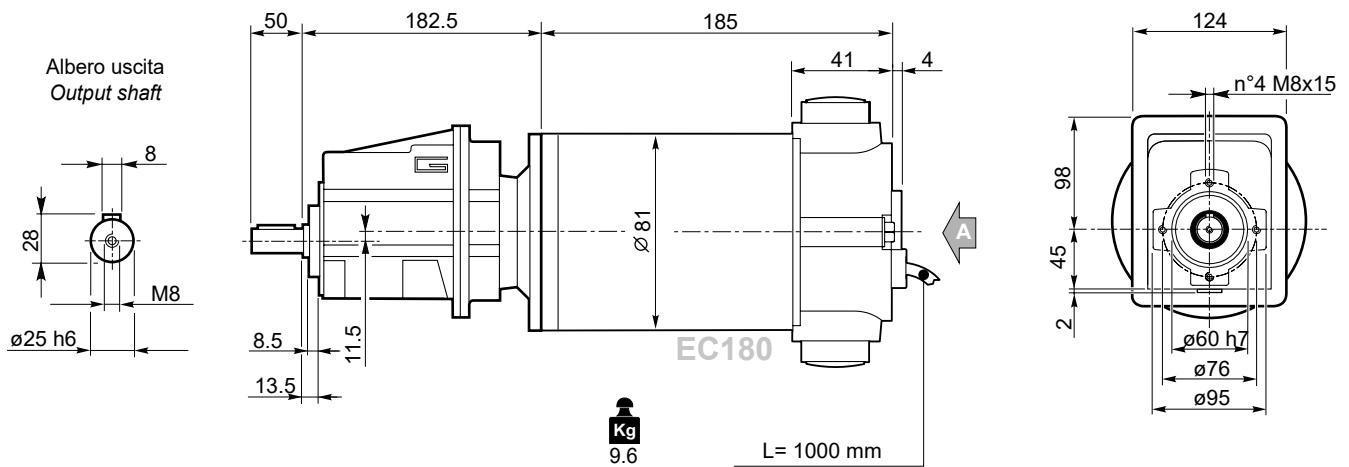

### ECMG180/023 U

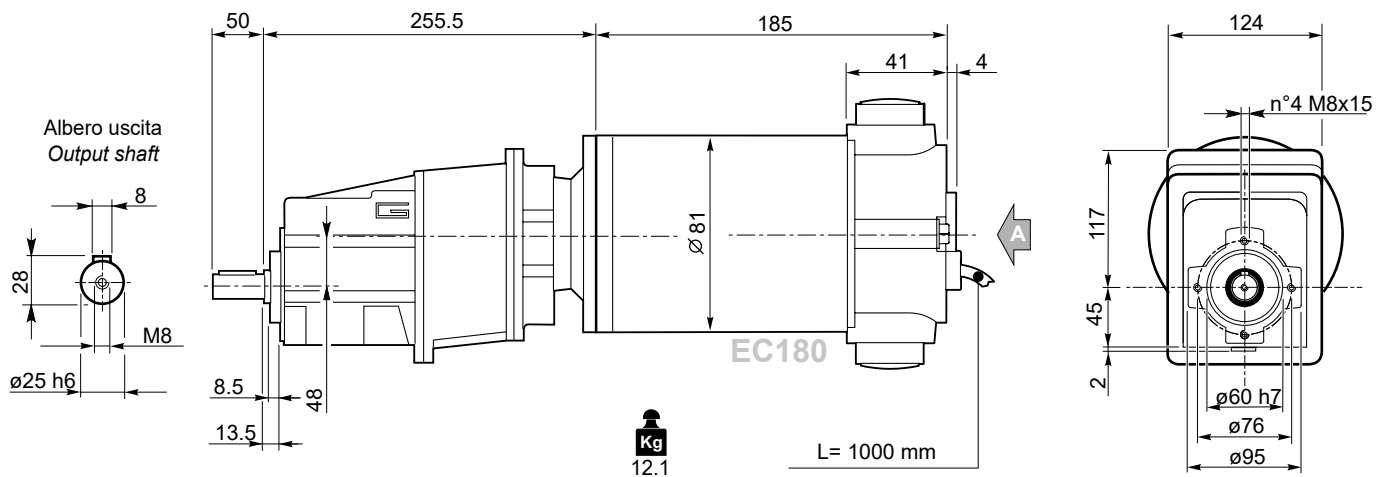

Vista da A  
View from A

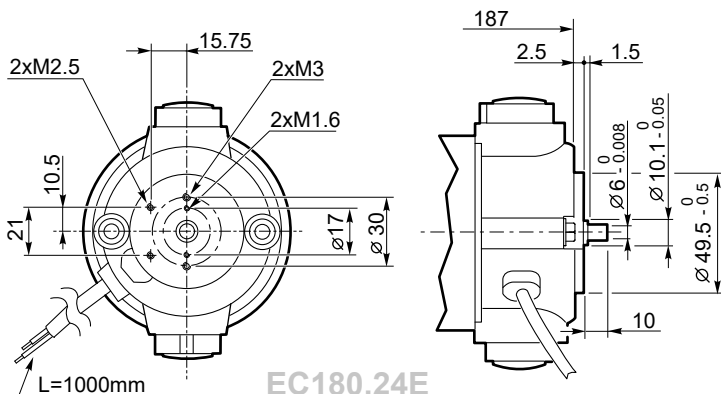

Freno / Brake

H23

Encoder

H24

Motori / Motors IP66

I6

ECMG...H

L30

ECMG...F

L31

ECMG...H/F

L32

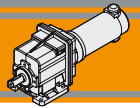

**Dimensioni**

**Dimensions**

**ECMG..U**

**ECMG180/033 U**

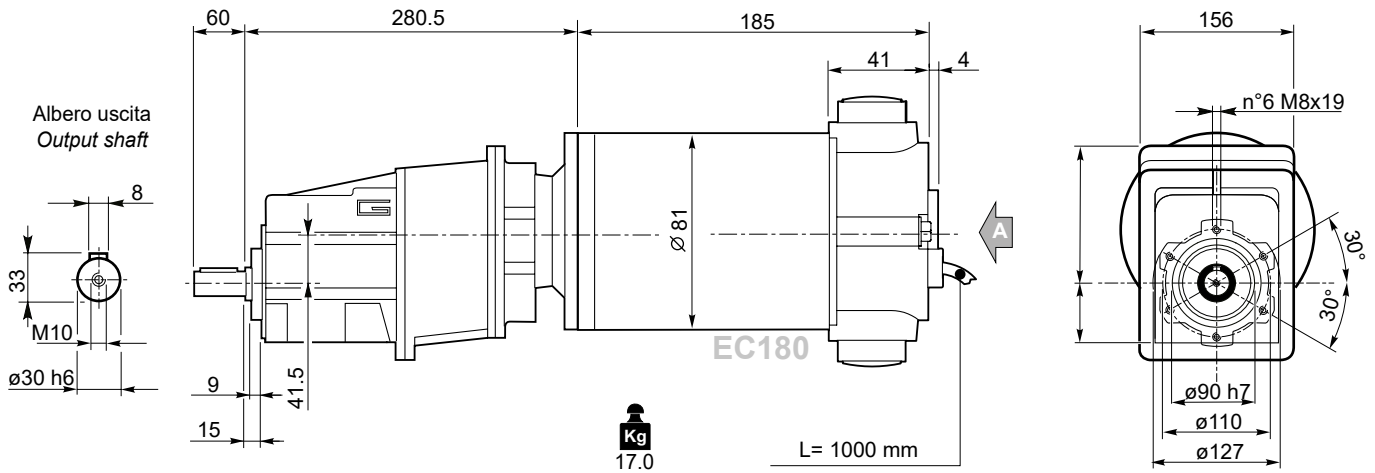

**ECMG180/043 U**

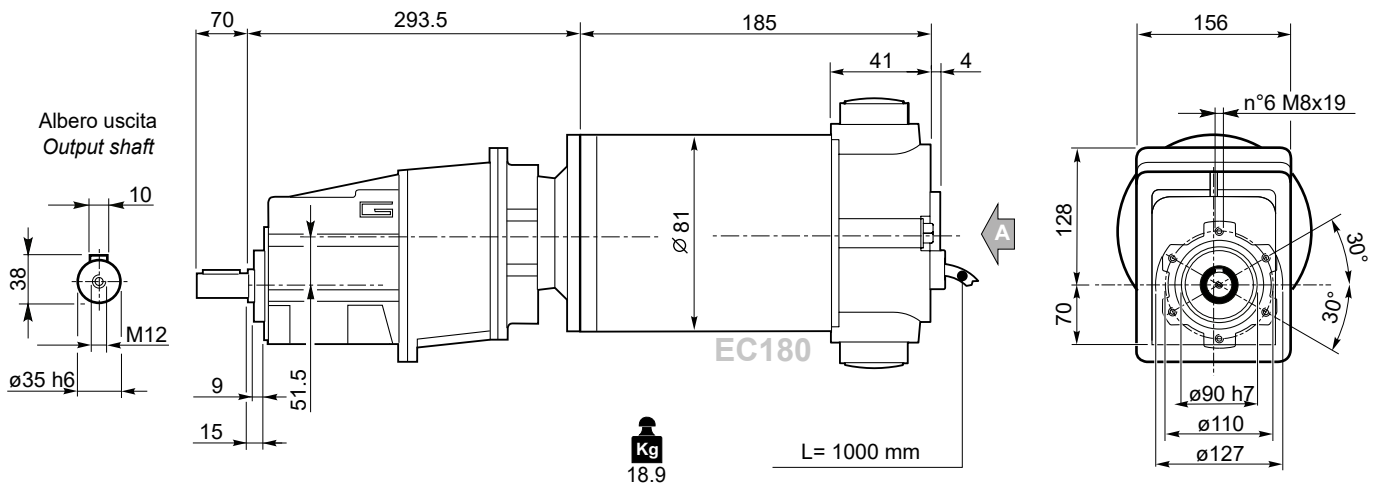

**ECMG**

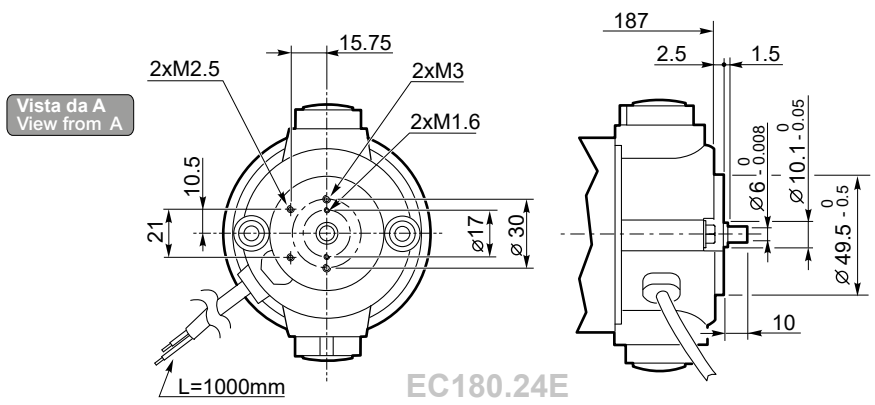

Freno / Brake → H23

Encoder → H24

Motori / Motors IP66 → I6

ECMG...H → L30

ECMG...F → L31

ECMG...H/F → L32

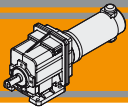

### Dimensioni

### Dimensions

## ECMG..U

### ECMG250/002 U

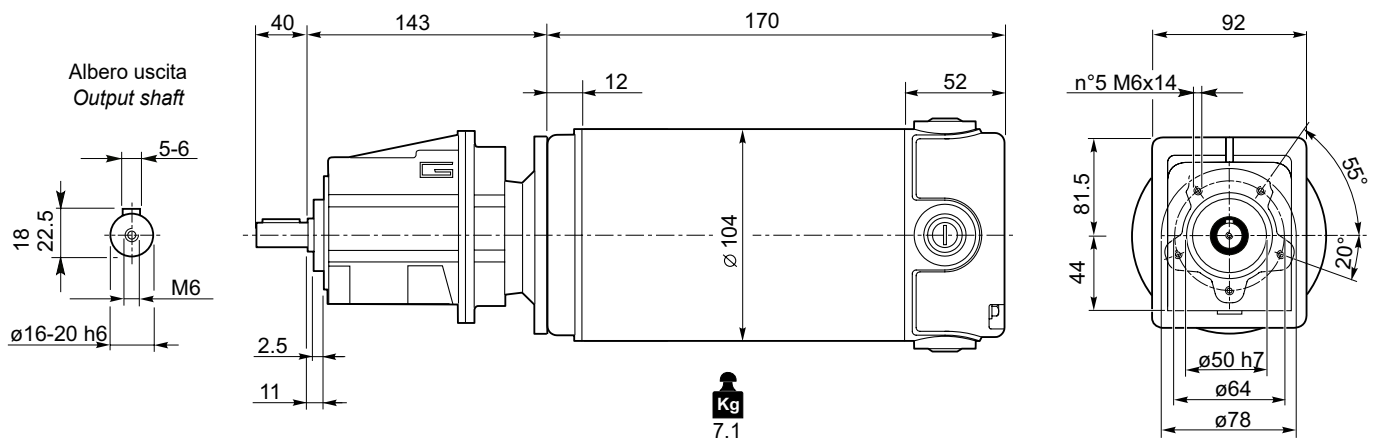

### ECMG250/012 U

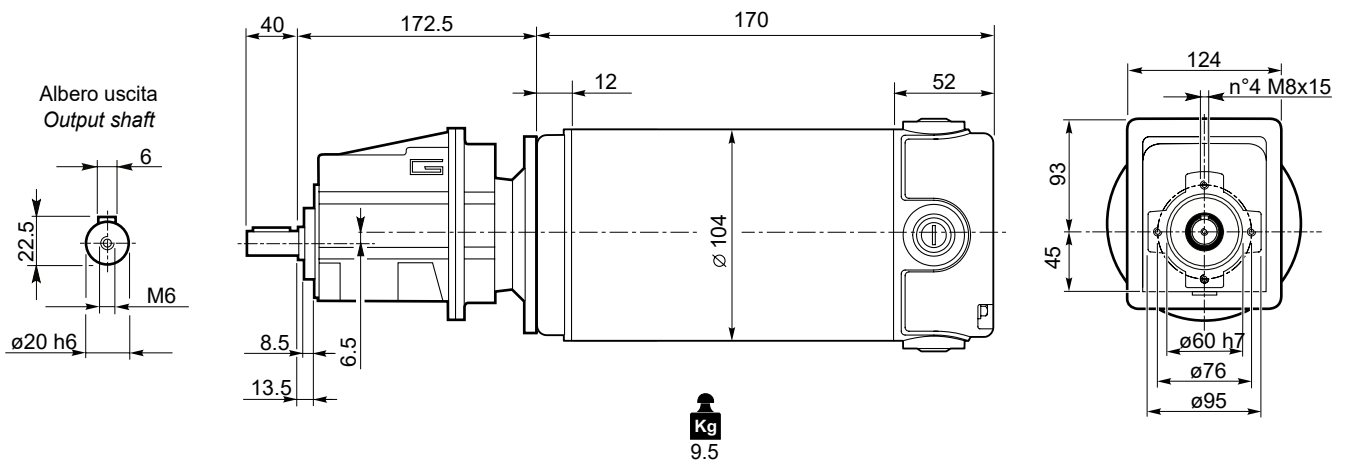

### ECMG250/013 U

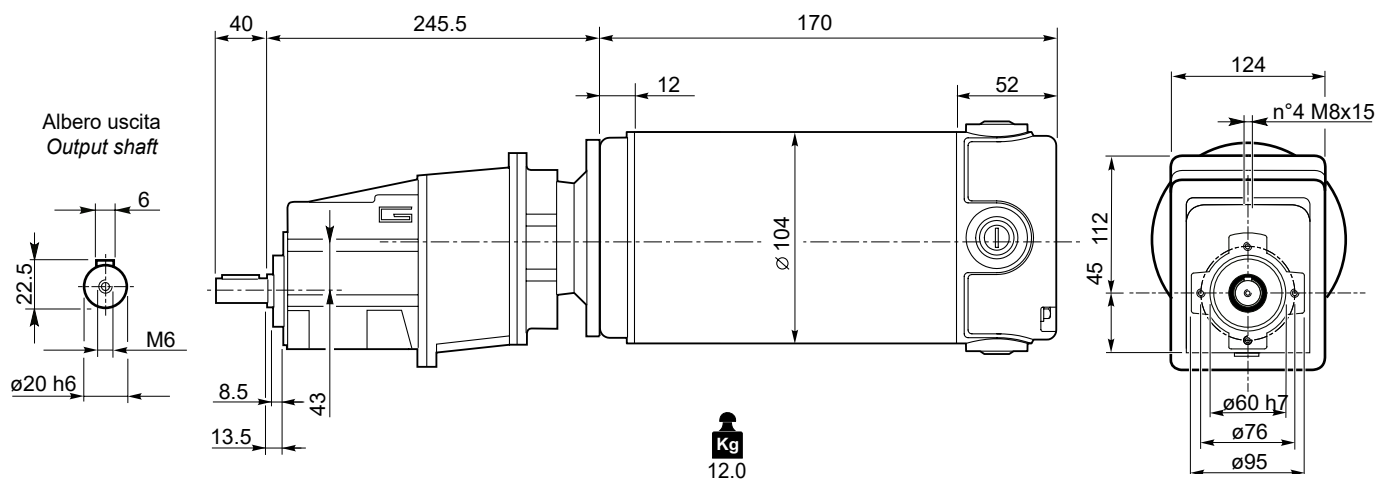

Motori / Motors IP66



ECMG...H



ECMG...F



ECMG...H/F



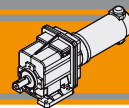

**Dimensioni**

**Dimensions**

**ECMG..U**

**ECMG250/022 U**

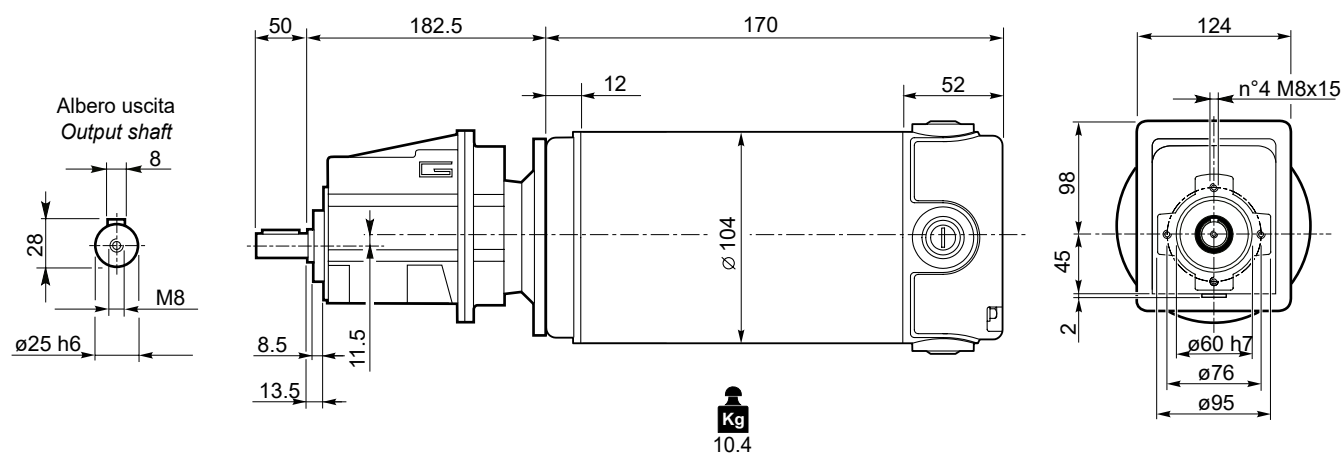

**ECMG250/023 U**

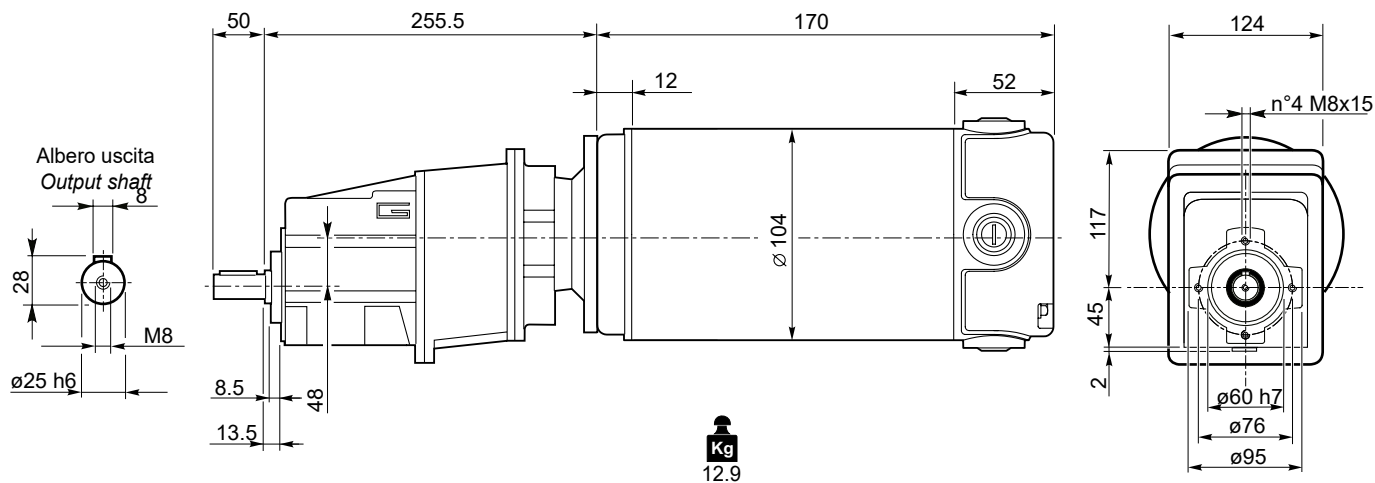

**ECMG**

Motori / Motors IP66



ECMG...H



ECMG...F



ECMG...H/F



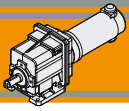

### Dimensioni

### Dimensions

## ECMG..U

### ECMG250/033 U

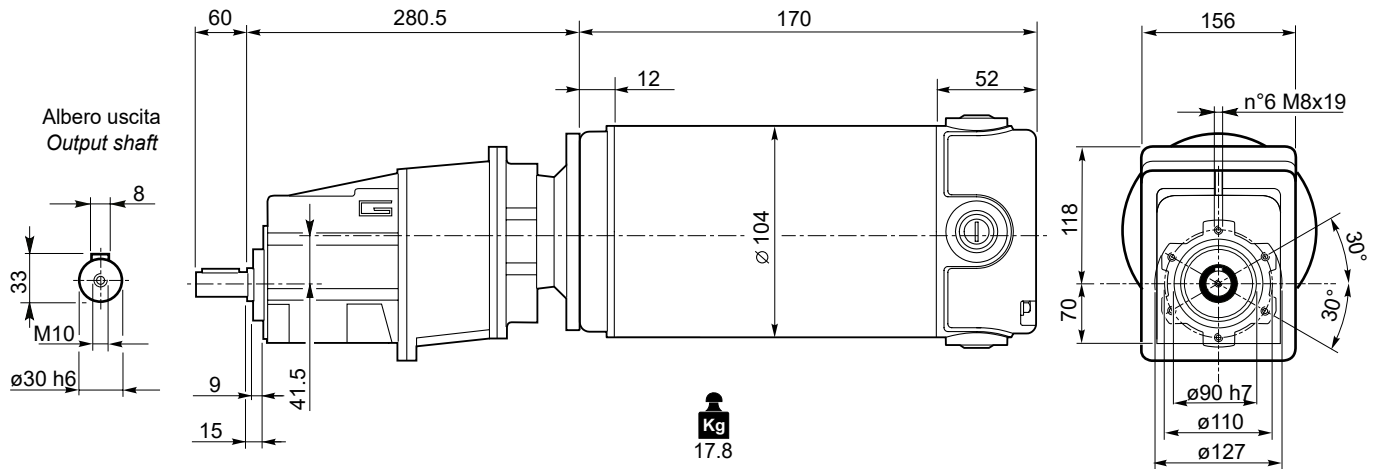

### ECMG250/043 U

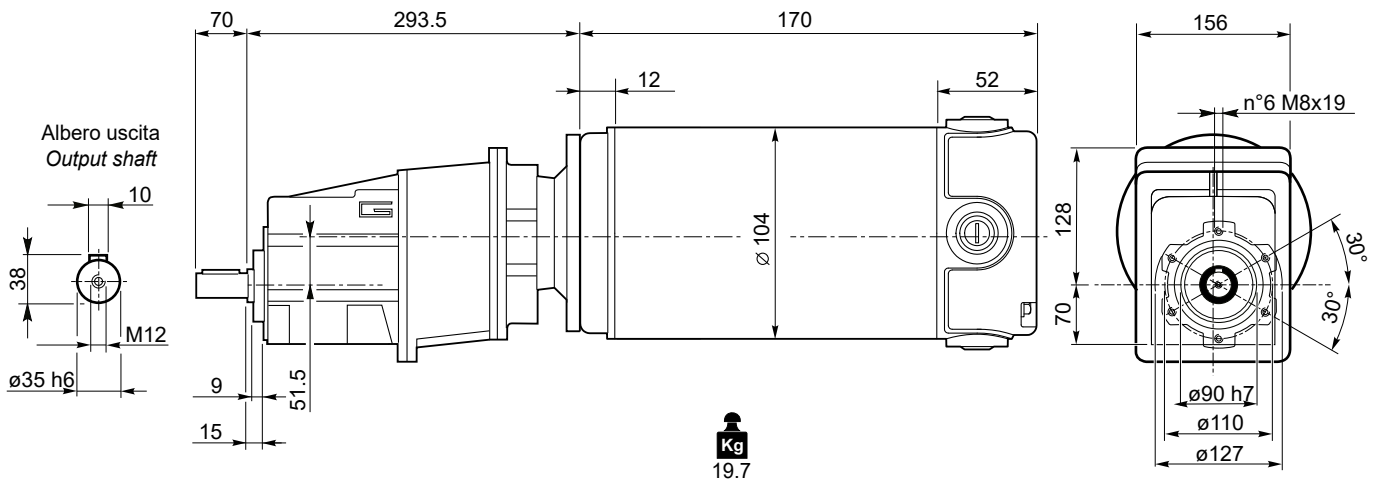



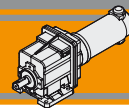

**Dimensioni**

**Dimensions**

**ECMG..U**

**ECMG350/002 U**

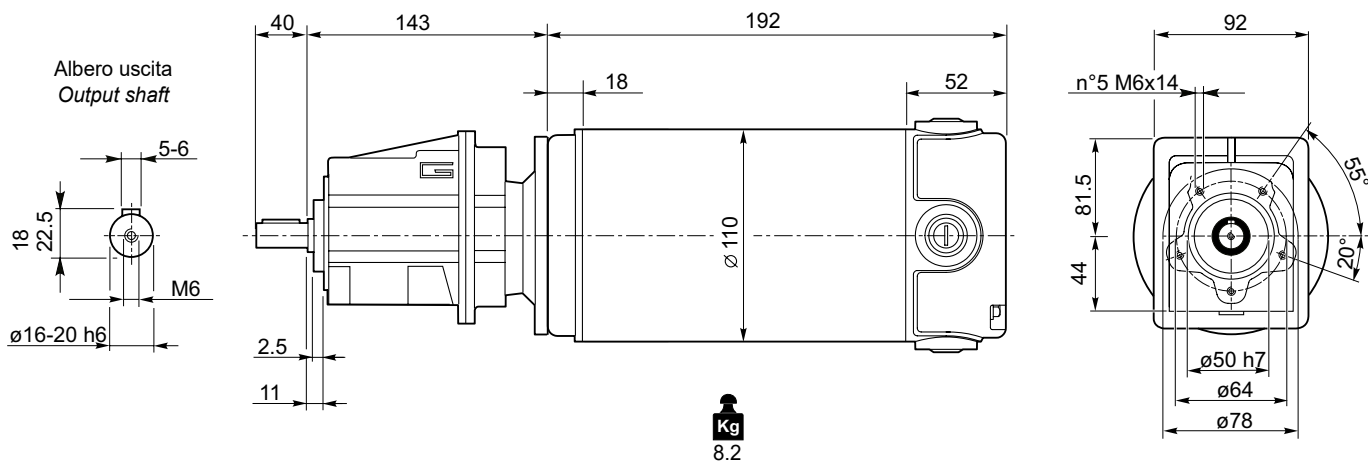

**ECMG350/012 U**

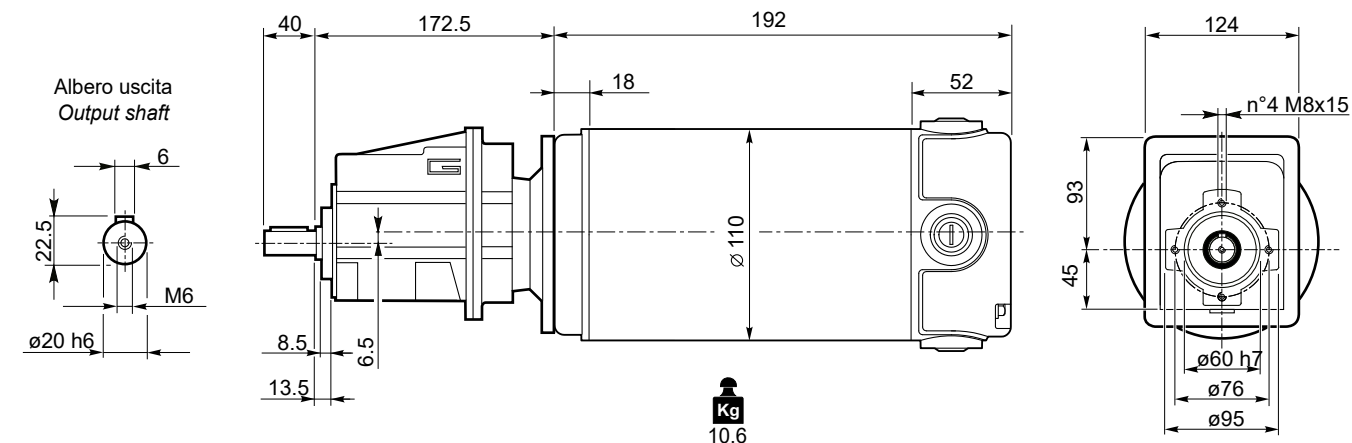

**ECMG350/013 U**

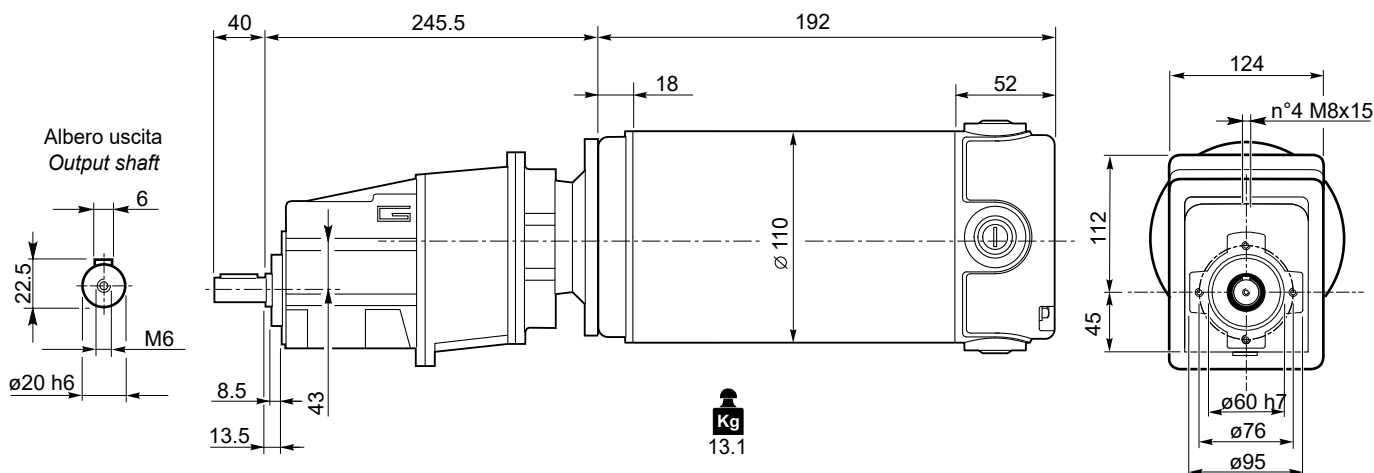

Freno / Brake



Motori / Motors IP66



ECMG...H



ECMG...F



ECMG...H/F



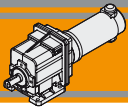

### Dimensioni

### Dimensions

## ECMG..U

### ECMG350/022 U

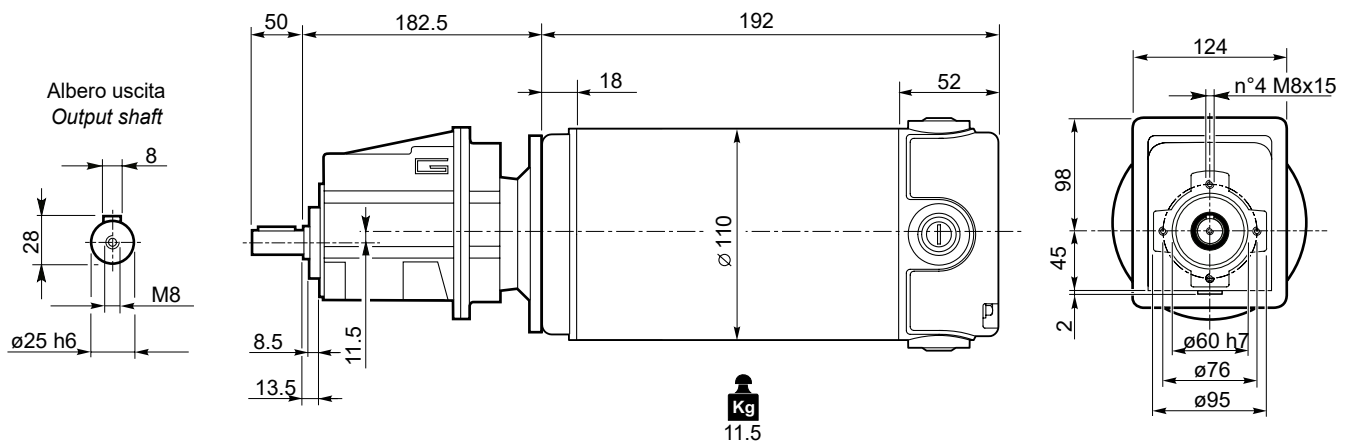

### ECMG350/023 U

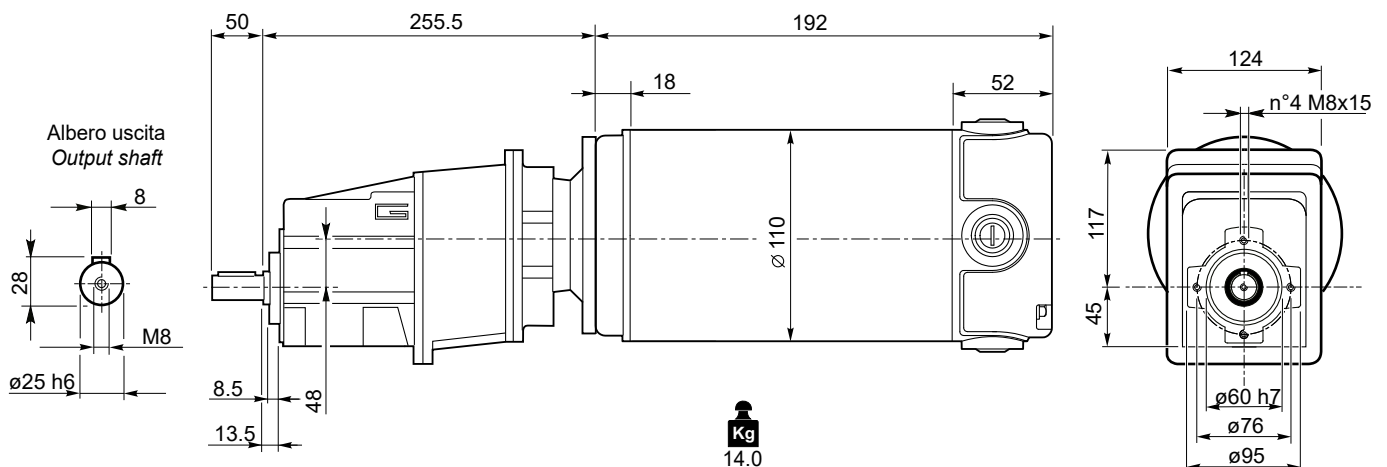

### ECMG350/032 U

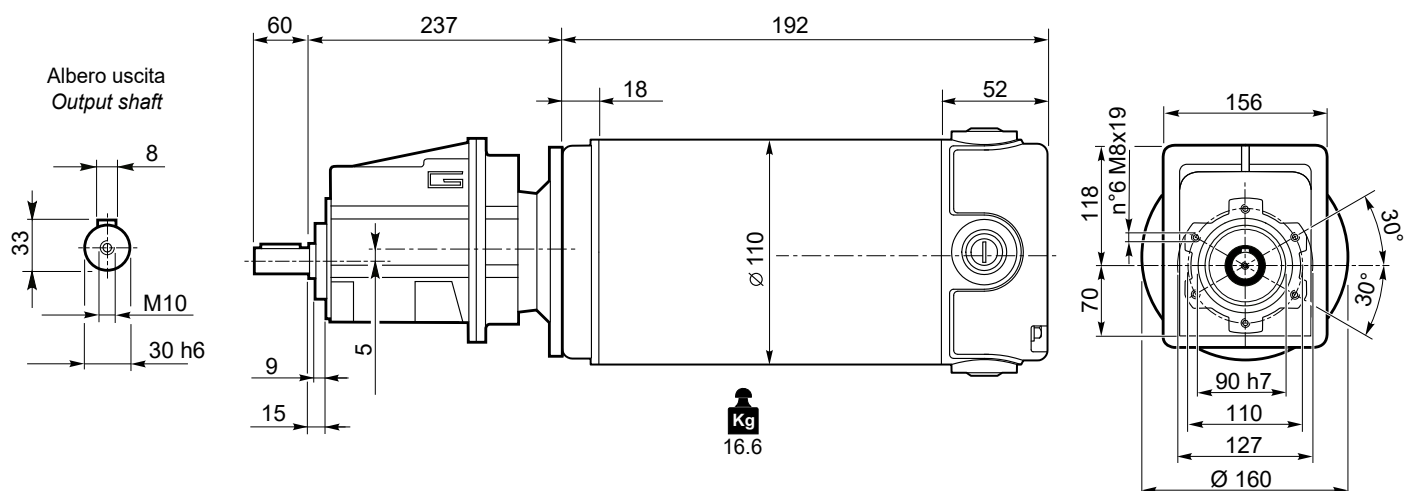

Freno / Brake



H23

ECMG...H



L30

ECMG...F



L31

ECMG...H/F



L32

Motori / Motors IP66



I10

Nota: Motore IP66 non disponibile per ECMG350/032  
Note: IP66 motor not available for ECMG350/032

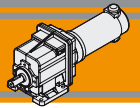

Dimensioni

Dimensions

ECMG..U

ECMG350/033 U

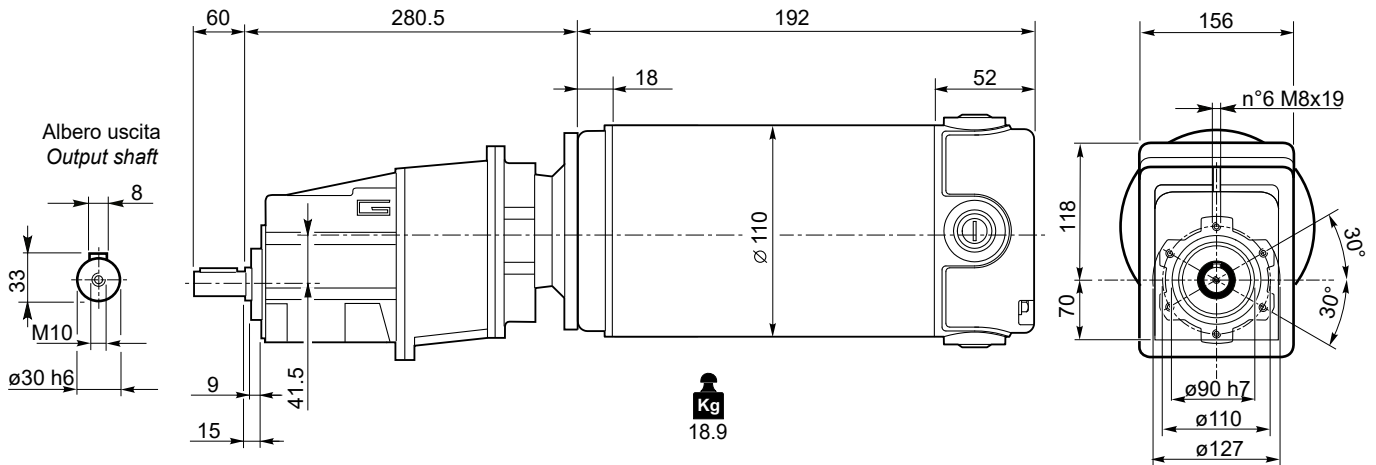

ECMG350/042 U

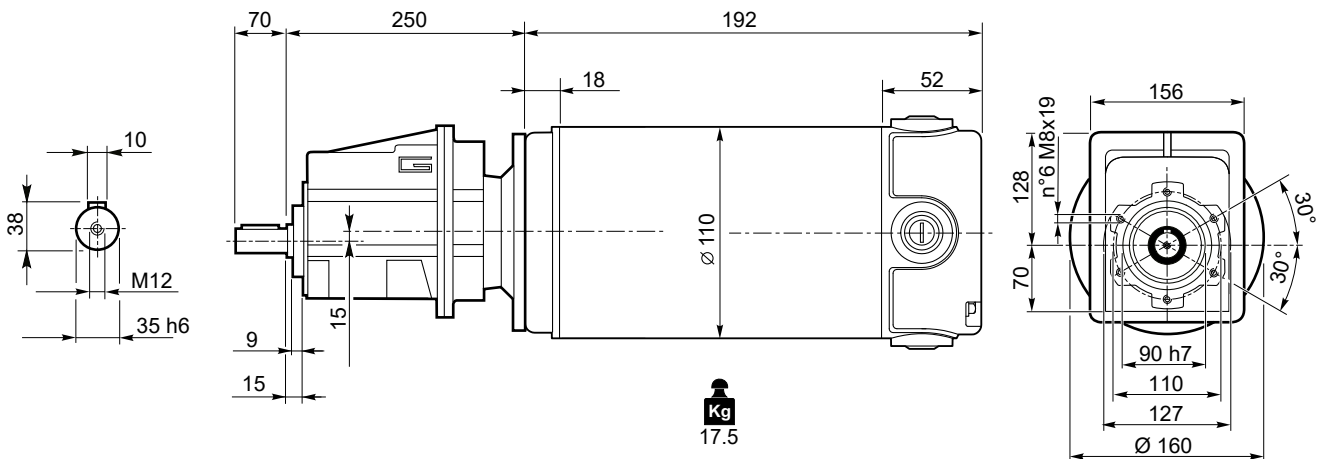

ECMG350/043 U

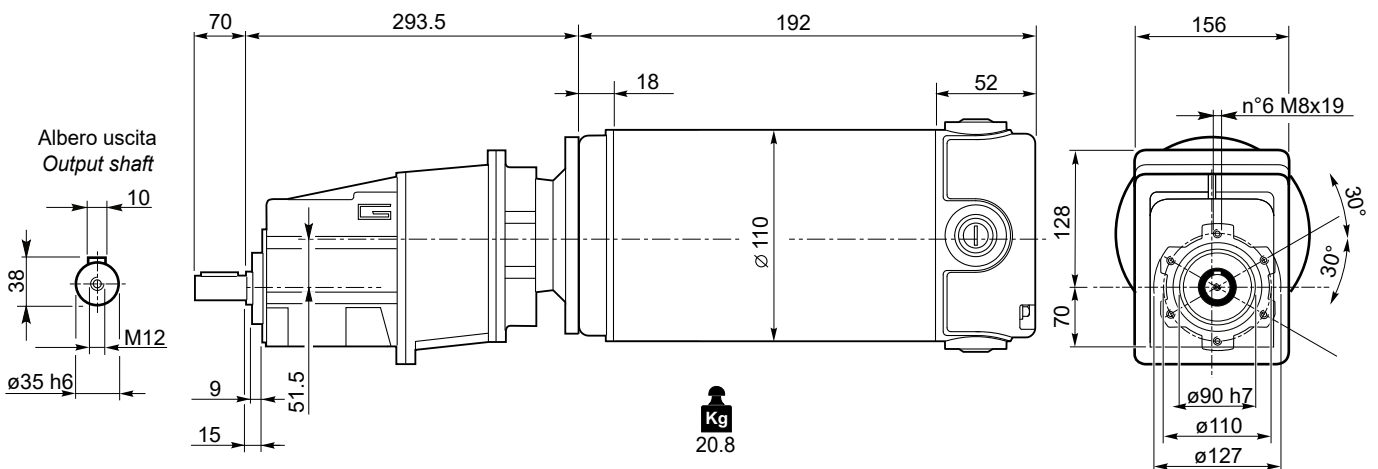

Freno / Brake



H23

ECMG...H



L30

ECMG...F



L31

ECMG...H/F



L32

Motori / Motors IP66



I10

Nota: Motore IP66 non disponibile per ECMG350/042  
Note: IP66 motor not available for ECMG350/042

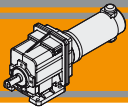

### Dimensioni

### Dimensions

## ECMG..U

### ECMG600/002 U

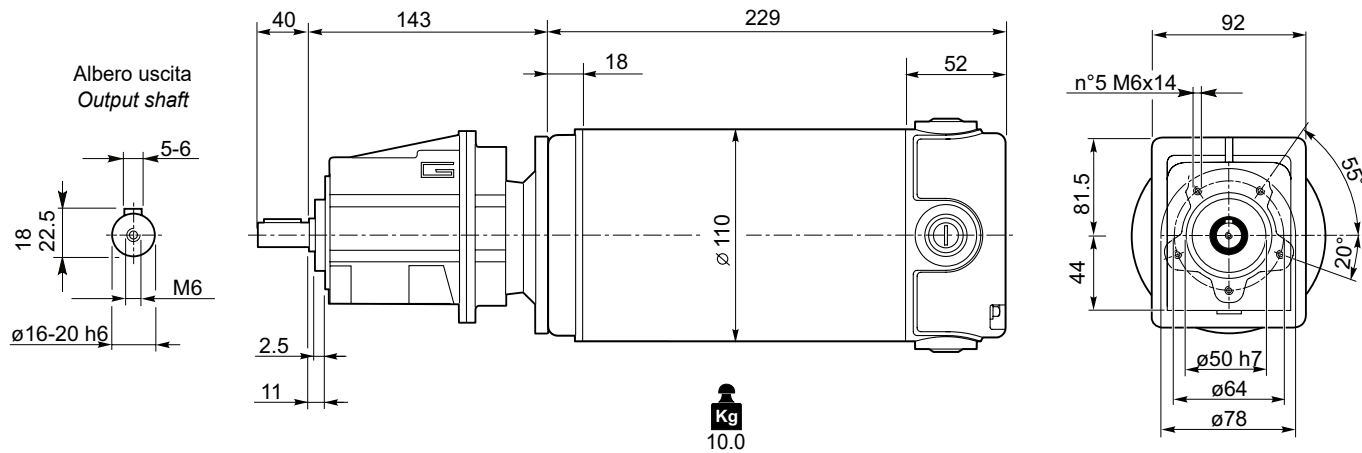

### ECMG600/002 U

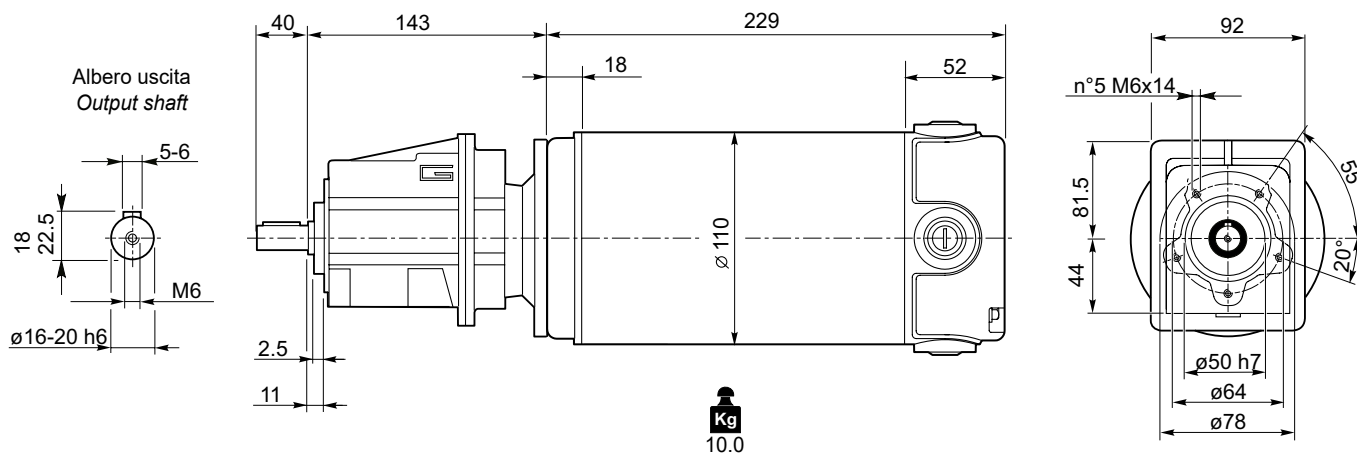

Freno / Brake



H23

Motori / Motors IP66



I12

ECMG...H



L30

ECMG...F



L31

ECMG...H/F



L32

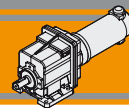

**Dimensioni**

**Dimensions**

**ECMG..U**

**ECMG600/012 U**

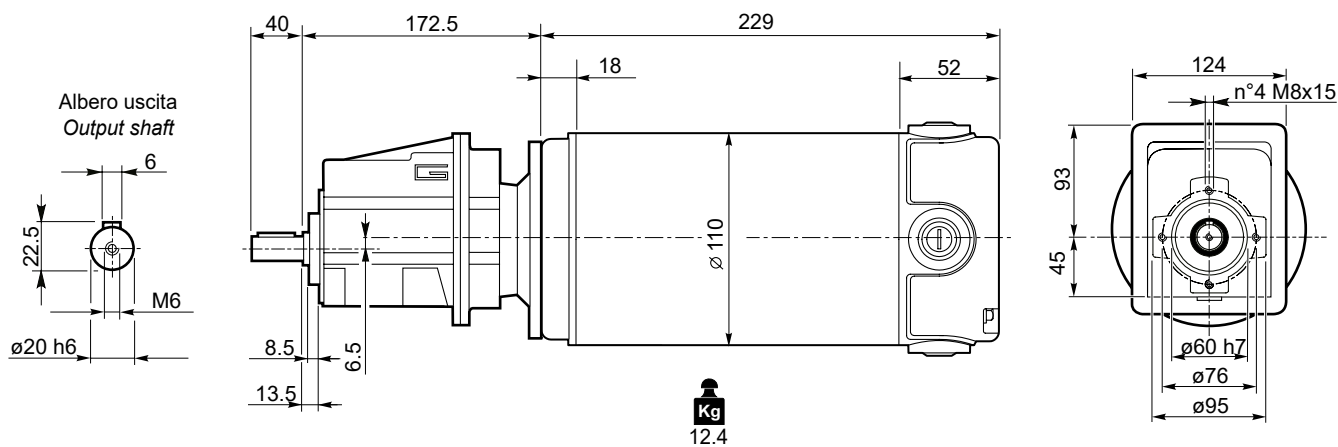

**ECMG600/013 U**

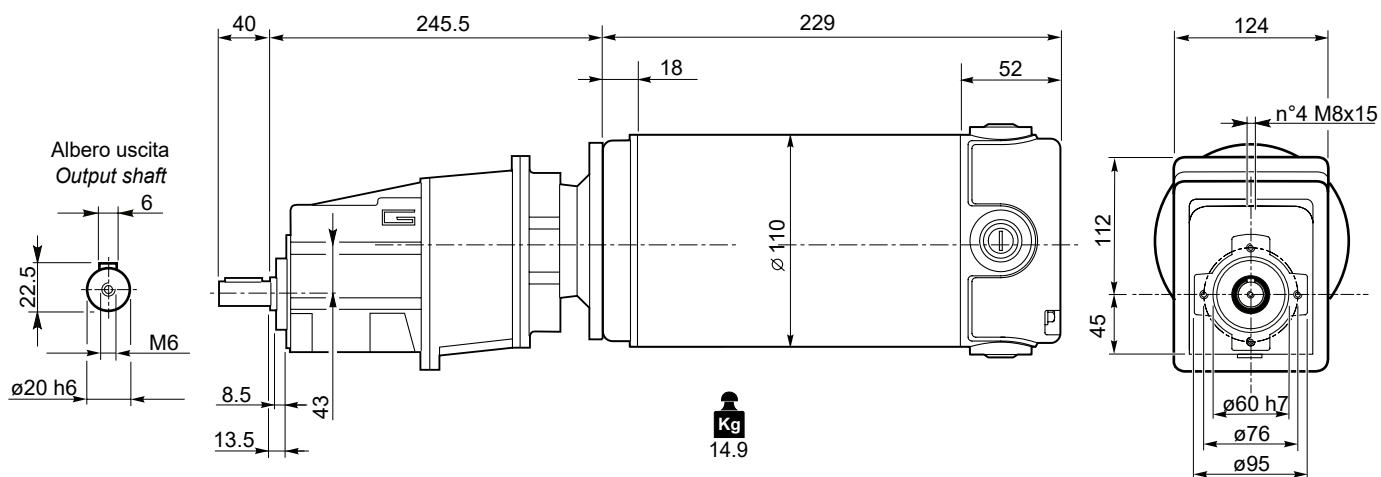

**ECMG**

Freno / Brake



H23

Motori / Motors IP66



I12

ECMG...H



L30

ECMG...F



L31

ECMG...H/F



L32

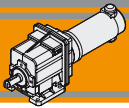

### Dimensioni

### Dimensions

## ECMG..U

### ECMG600/022 U

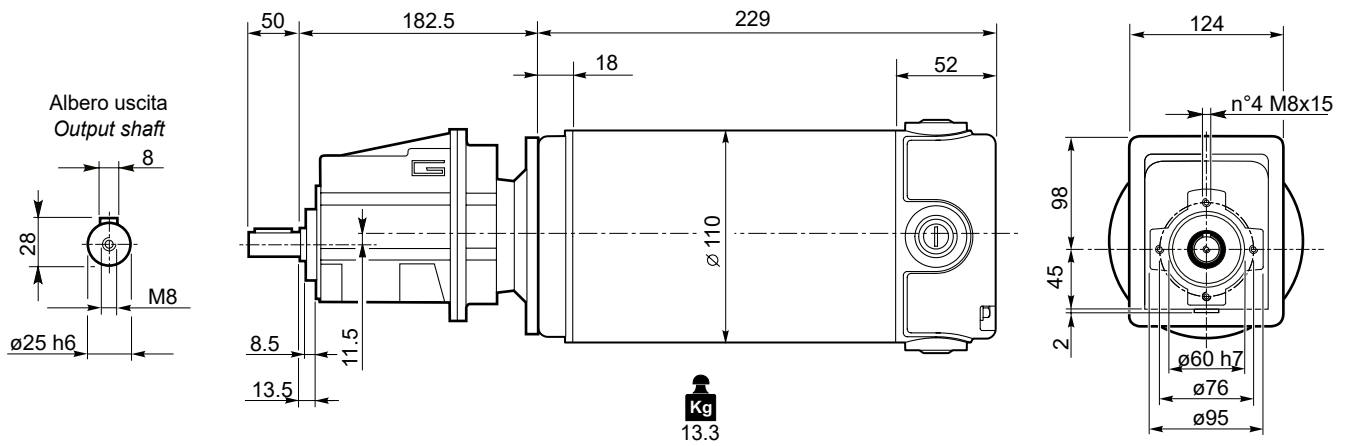

### ECMG600/023 U

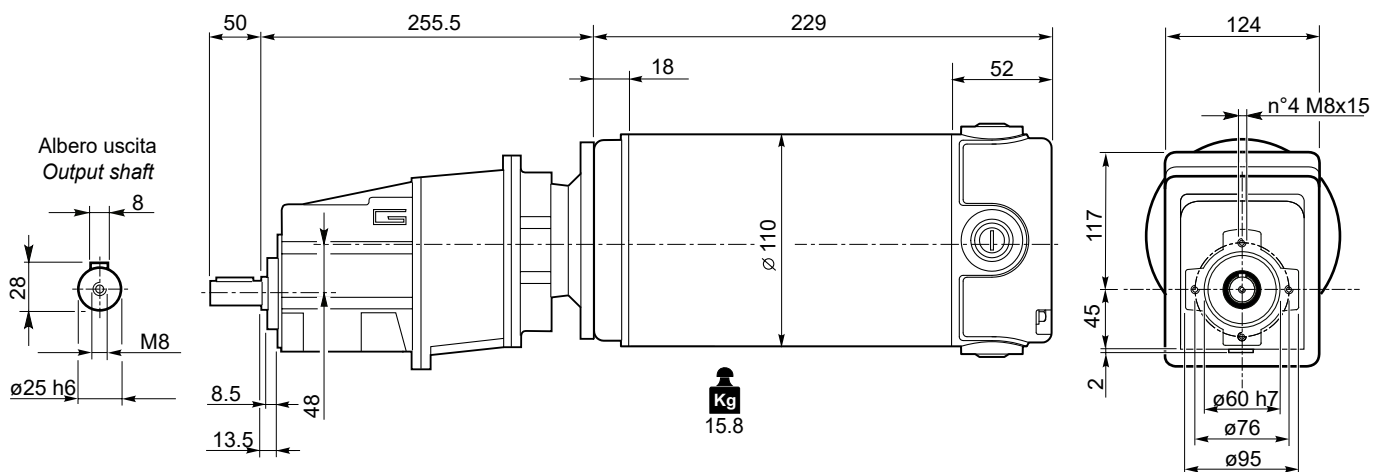

### ECMG600/032 U

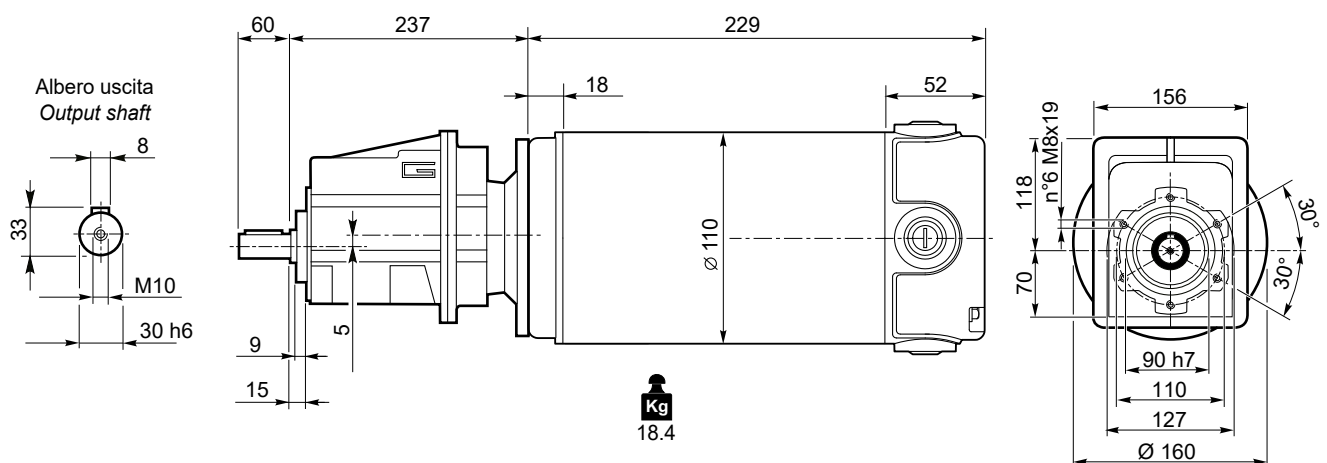

Freno / Brake



H23

ECMG...H



L30

ECMG...F



L31

ECMG...H/F



L32

Motori / Motors IP66



I12

Nota: Motore IP66 non disponibile per ECMG600/032  
Note: IP66 motor not available for ECMG600/032

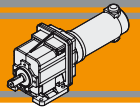

Dimensioni

Dimensions

ECMG..U

ECMG600/033 U

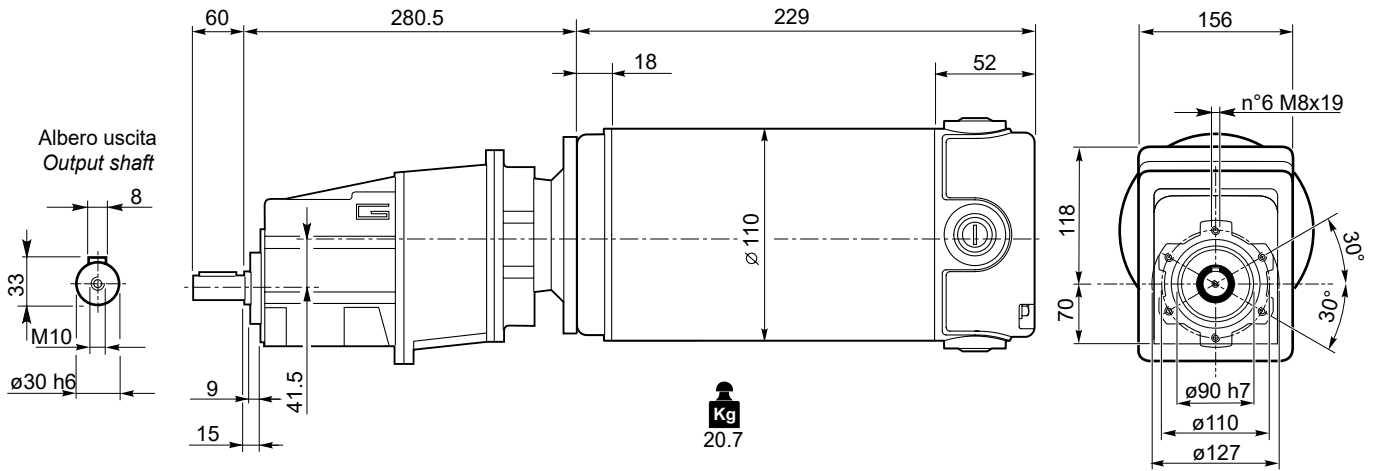

ECMG600/042 U

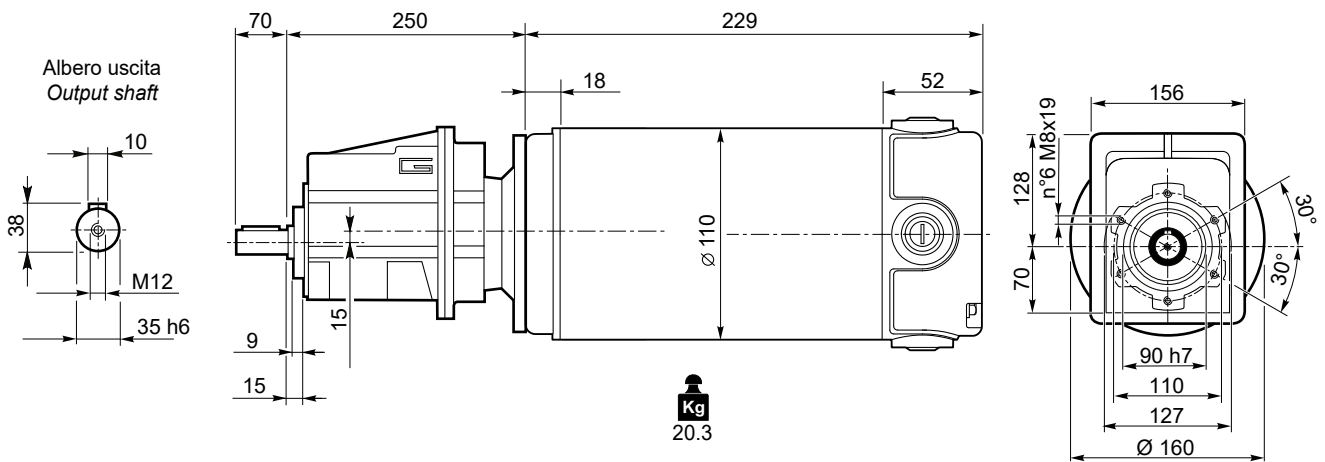

ECMG600/043 U

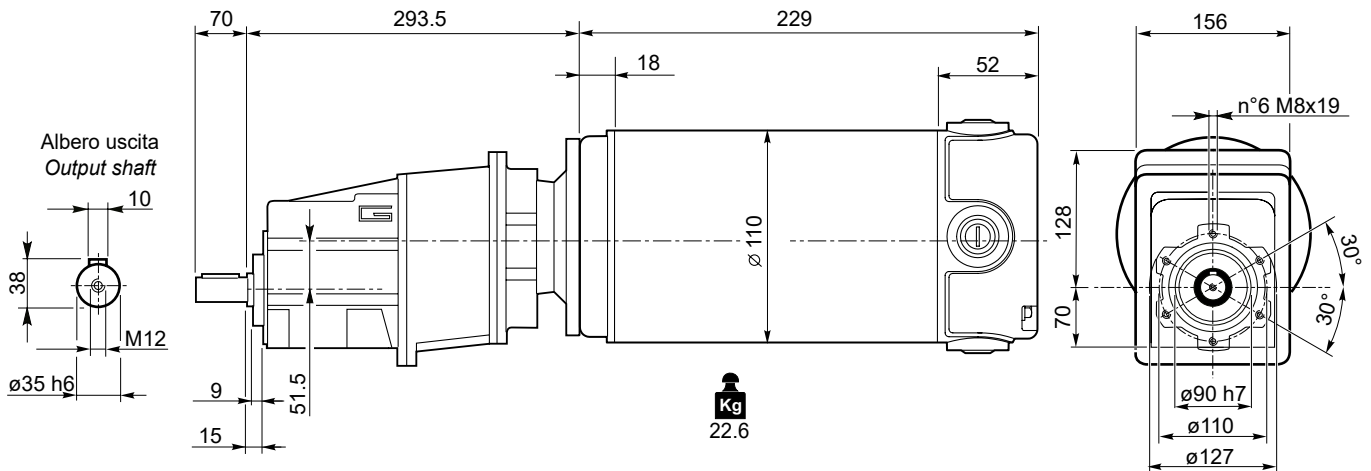

Freno / Brake

H23

ECMG...H

L30

ECMG...F

L31

ECMG...H/F

L32

Motori / Motors IP66

I12

Nota: Motore IP66 non disponibile per ECMG600/042  
Note: IP66 motor not available for ECMG600/042

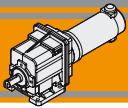

### Dimensioni

### Dimensions

## ECMG..H

### ECMG..2 H..

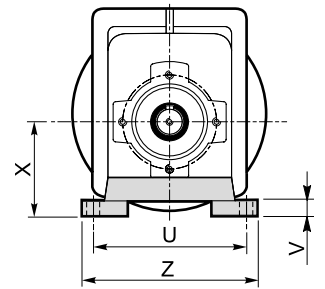
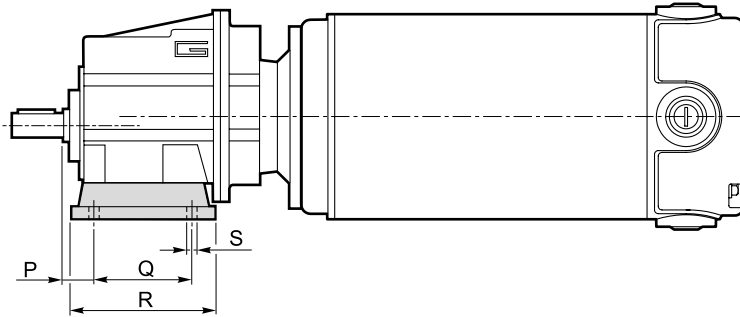

### ECMG..3 H..

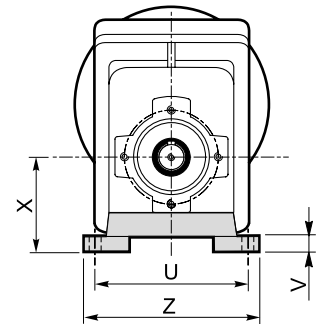
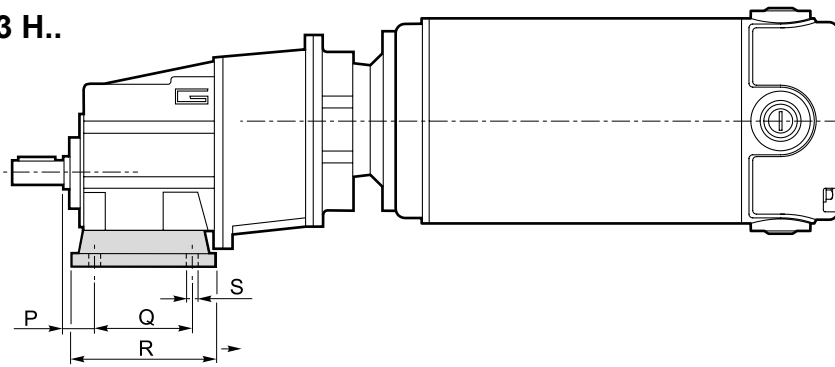

#### Versione H / H Version

CMG	P	Q	R	S	U	V	X	Z	Piede / Foot	
									Tipo / Type	Peso / Weight [kg]
002	18	60	80	9	100	10	60	120	H60	0.2
	18	80	104	9	110 - 120	10	75	145	H75	0.3
	18	50 - 87	110	9	110	10	85	135	H85	0.4
012 013	20	85	108	9	115	12	65	139	H65	0.7
	18	80	118	9	110	12	75	140	H75	1.0
	25	85	120	9	120	12	80	140	H80	1.1
	18	50 - 87	118	9	110	12	85	130	H85	1.2
	25	130	154	9	110	12	90	135	H90	1.5
	18	60 - 107.5	135	11	130	12	100	155	H100	1.7
022 023	20	85	108	9	115	12	65	139	H65	0.7
	18	80	118	9	110	12	75	140	H75	1.0
	25	85	120	9	120	12	80	140	H80	1.1
	18	50 - 87	118	9	110	12	85	130	H85	1.2
	25	130	154	9	110	12	90	135	H90	1.5
	18	60 - 107.5	135	11	130	12	100	155	H100	1.7
032 033	30	105	136	14	160	14	95	194	H95	1.5
	30	100	150	11	150	14	110	185	H110	1.9
	18	70			160					
	30	165	195	14	135	14	115	170	H115	2.2
	35	110	160	14	170	14	120	210	H120	2.6
042 043	30	105	136	14	160	14	95	194	H95	1.5
	30	100	150	11	150	14	110	185	H110	1.9
	18	70			160					
	30	165	195	14	135	14	115	170	H115	2.2
	35	110	160	14	170	14	120	210	H120	2.6

Preferenziale / Preferred



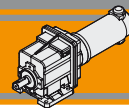

Dimensioni

Dimensions

**ECMG..F**

**ECMG..2 F..**

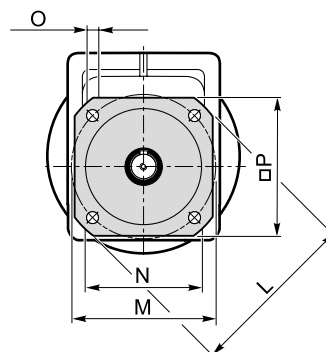
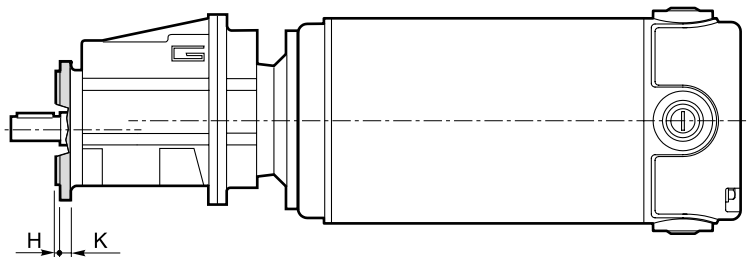

**ECMG..3 F..**

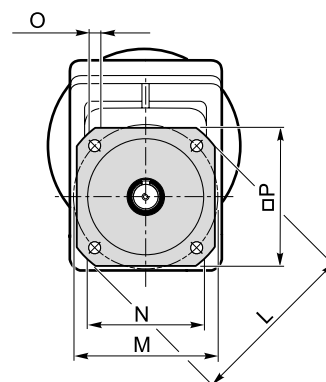
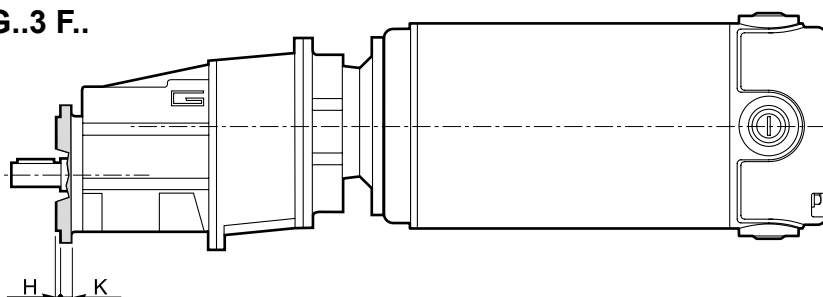

Versione F / F Version									
CMG	H	K	L	M	N f7	O	P	Flangia / Flange	
								Tipo / Type	Peso / Weight [kg]
<b>002</b>	3.5	7	105	85	70	6.5	90	<b>F105</b>	0.1
	3.5	8	120	100	80	7	100	<b>F120</b>	0.2
	3.5	8	140	115	95	9	115	<b>F140</b>	0.2
<b>012</b> <b>013</b>	3	9	120	100	80	9	106	<b>F120</b>	0.5
	3.5	9	140	115	95	9	115	<b>F140</b>	0.8
	3.5	9	160	130	110	9	126	<b>F160</b>	1.1
	3.5	11	200	165	130	11	165	<b>F200</b>	1.8
<b>022</b> <b>023</b>	3	9	120	100	80	9	106	<b>F120</b>	0.5
	3.5	9	140	115	95	9	115	<b>F140</b>	0.8
	3.5	9	160	130	110	9	126	<b>F160</b>	1.1
	3.5	11	200	165	130	11	165	<b>F200</b>	1.8
<b>032</b> <b>033</b>	3.5	11	160	130	110	9	140	<b>F160</b>	1.0
	3.5	11	200	165	130	11	165	<b>F200</b>	1.8
	4	13	250	215	180	14	215	<b>F250</b>	2.9
<b>042</b> <b>043</b>	3.5	11	160	130	110	9	140	<b>F160</b>	1.0
	3.5	11	200	165	130	11	165	<b>F200</b>	1.8
	4	13	250	215	180	14	215	<b>F250</b>	2.9

**ECMG**

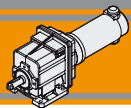

### Dimensioni

### Dimensions

Versione H / H Version											Combinazioni possibili H/F Possible combinations H/F						
CMG	P	Q	R	S	U	V	X	Z	Piede / Foot		F105	F120	F140	F160	F200	F250	F300
									Tipo / Type	Peso / Weight [kg]							
002	18	60	80	9	100	10	60	120	H60	0.2	•	•	•				
	18	80	104	9	110 - 120	10	75	145	H75	0.3	•	•	•				
	18	50 - 87	110	9	110	10	85	135	H85	0.4	•	•	•				
012 013	20	85	108	9	115	12	65	139	H65	0.7		•	•				
	18	80	118	9	110	12	75	140	H75	1.0		•	•	•			
	25	85	120	9	120	12	80	140	H80	1.1		•	•	•			
	18	50 - 87	118	9	110	12	85	130	H85	1.2		•	•	•			
	25	130	154	9	110	12	90	135	H90	1.5		•	•	•	•		
	18	60 - 107.5	135	11	130	12	100	155	H100	1.7		•	•	•	•		
022 023	20	85	108	9	115	12	65	139	H65	0.7		•	•				
	18	80	118	9	110	12	75	140	H75	1.0		•	•	•			
	25	85	120	9	120	12	80	140	H80	1.1		•	•	•			
	18	50 - 87	118	9	110	12	85	130	H85	1.2		•	•	•			
	25	130	154	9	110	12	90	135	H90	1.5		•	•	•	•		
	18	60 - 107.5	135	11	130	12	100	155	H100	1.7		•	•	•	•		
032 033	30	105	136	14	160	14	95	194	H95	1.5				•	•		
	30	100	150	11	150	14	110	185	H110	1.9				•	•		
	18	70			160												
	30	165	195	14	135	14	115	170	H115	2.2				•	•	•	
	35	110	160	14	170	14	120	210	H120	2.6				•	•	•	
042 043	30	105	136	14	160	14	95	194	H95	1.5				•	•		
	30	100	150	11	150	14	110	185	H110	1.9				•	•		
	18	70			160												
	30	165	195	14	135	14	115	170	H115	2.2				•	•	•	
	35	110	160	14	170	14	120	210	H120	2.6				•	•	•	

■ Preferenziale / Preferred

• Combinazioni possibili H/F / Possible combinations H/F

Versione F / F Version									
CMG	H	K	L	M	N f7	O	P	Flangia / Flange	
								Tipo / Type	Peso / Weight [kg]
002	3.5	7	105	85	70	6.5	90	F105	0.1
	3.5	8	120	100	80	7	100	F120	0.2
	3.5	8	140	115	95	9	115	F140	0.2
012 013	3	9	120	100	80	9	106	F120	0.5
	3.5	9	140	115	95	9	115	F140	0.8
	3.5	9	160	130	110	9	126	F160	1.1
	3.5	11	200	165	130	11	165	F200	1.8
022 023	3	9	120	100	80	9	106	F120	0.5
	3.5	9	140	115	95	9	115	F140	0.8
	3.5	9	160	130	110	9	126	F160	1.1
	3.5	11	200	165	130	11	165	F200	1.8
032 033	3.5	11	160	130	110	9	140	F160	1.0
	3.5	11	200	165	130	11	165	F200	1.8
	4	13	250	215	150	14	215	F250	2.9
042 043	3.5	11	160	130	110	9	140	F160	1.0
	3.5	11	200	165	130	11	165	F200	1.8
	4	13	250	215	150	14	215	F250	2.9

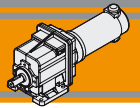

Dimensioni

Dimensions

ECMG..H../F..

ECMG..2 H../F..

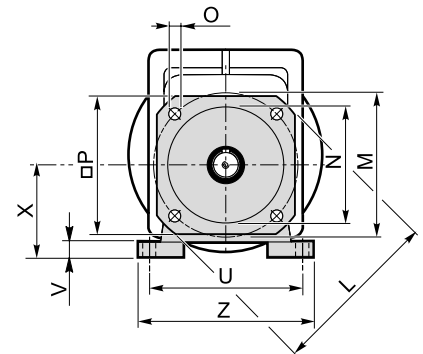
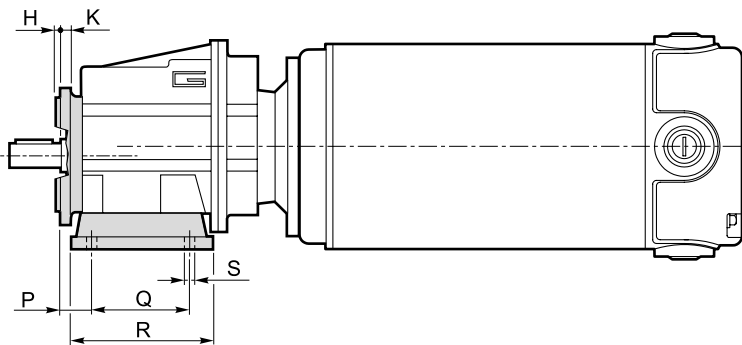

ECMG..3 H../F..

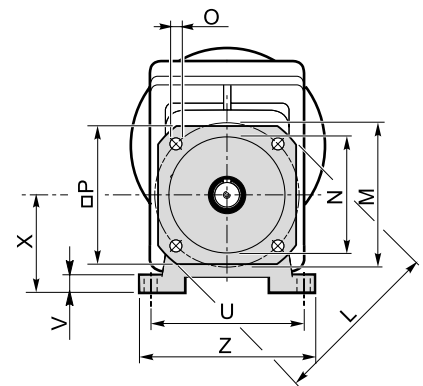
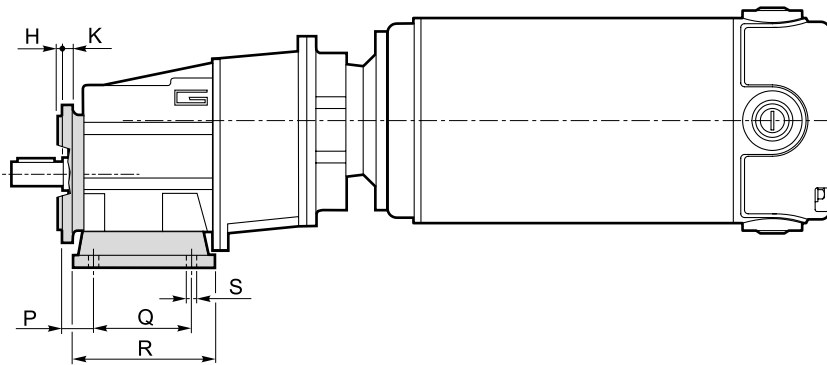





**MA TRANSTECNO S.A.P.I. DE C.V.**  
 Av. Mundial # 176, Parque Industrial  
 JM Apodaca, Nuevo León,  
 C.P. 66600  
 MÉXICO  
 T +52 8113340920  
 info@transtecno.com.mx  
 www.transtecno.com.mx



**TRANSTECNO SRL**  
 Via Caduti di Sabbiano, 11/D-E  
 40011 Anzola dell'Emilia (BO)  
 ITALY  
 T+39 051 64 25 811  
 F +39 051 73 49 43  
 sales@transtecno.com  
 www.transtecno.com



**HANGZHOU TRANSTECNO POWER  
 TRANSMISSIONS CO LTD**  
 No.4 Xiuyan Road Fengdu Industry Zone  
 Pingyao Town Yuhang District  
 Hangzhou City, Zhejiang Province  
 311115 – CHINA  
 T +86 571 86 92 02 60  
 F +86 571 86 92 18 10  
 info-china@transtecno.com  
 www.transtecno.cn



**TRANSTECNO U.S.A. LLC**  
 5440 S.W. 156th Place Miami,  
 FL 33185 - USA  
 Tel: +1 (305) 220-4423  
 Fax: +1 (305) 220-5945  
 usaoffice@transtecno.com



**TRANSTECNO B.V.**  
 Ind. terrein Wieken/Vinkenhof  
 De Stuwdam,43  
 3815 KM Amersfoort - NETHERLANDS  
 Tel: +31(0) 33 45 19 505  
 Fax: +31(0) 33 45 19 506  
 info@transtecno.nl  
 www.transtecno.nl



**SALES OFFICE INDIA**  
 A/10, Anagha, S.N. Road, Mulund (W) Mumbai  
 400080 - INDIA  
 Tel: +91 9820614698  
 Fax-Italy: +39 051 73 49 43  
 indiaoffice@transtecno.com



**SALES OFFICE BRAZIL**  
 Rua Dr. Freire Alemão 155 / 402 - CEP. 90450-060  
 Auxiliadora Porto Alegre RS - BRAZIL  
 Tel: +55 51 3251 5447  
 Fax: +55 51 3251 5447  
 Mobile: +55 51 811 45 962  
 braziloffice@transtecno.com  
 www.transtecno.com.br



**TRANSTECNO AANDRIJFTECHNIEK B.V.**  
 De Stuwdam 43  
 3815 KM Amersfoort - NETHERLANDS  
 Tel: +31 (0) 33 20 4 7 006  
 info@transtecnoaandrijftechnik.nl  
 www.transtecnoaandrijftechnik.nl



**SALES OFFICE SOUTH KOREA**  
 D-304 Songdo BRC Smart Valley 30, Songdomirae-ro,  
 Yeonsu-gu, Incheon, 406-840 - KOREA  
 Tel: +82 70 8288 2107  
 Fax: +82 32 815 2107  
 Mobile: +82 10 5094 2107  
 koreaoffice@transtecno.com



**TRANSTECNO IBÉRICA  
 THE MODULAR GEARMOTOR, S.A.**  
 C/Enginy, 2 Nave 6 - 08850 Gavà (Barcelona) - SPAIN  
 Tel: +34 931 598 950  
 info@transtecno.es  
 www.transtecno.es



**SALES OFFICE OCEANIA**  
 44 Northview drive, Sunshine west 3020  
 Victoria - AUSTRALIA  
 Ph +61 03 9312 4722  
 Fax +61 03 9312 4714  
 Mobile: +61 0438060997  
 oceaniaoffice@transtecno.com  
 www.transtecno.com.au



**SALES OFFICE FRANCE**  
 Tel: +33 (0) 6 85 12 09 87  
 Fax-Italy: +39 051 73 49 43  
 franceoffice@transtecno.com  
 www.transtecno.fr

  
**TRANSTECNO**<sup>®</sup>  
 the modular gearmotor  
 www.transtecno.com